

# Swedish Minor Skybridge Term Permit



Seattle City Council Transportation Committee

Amy Gray

September 14, 2016

# Our mission, vision, and core values

**Mission:** deliver a high-quality transportation system for Seattle

**Vision:** connected people, places, and products

Committed to **5 core values** to create a city that is:

- Safe
- Interconnected
- Affordable
- Vibrant
- Innovative

For **all**

# Swedish Minor Skybridge Area Map

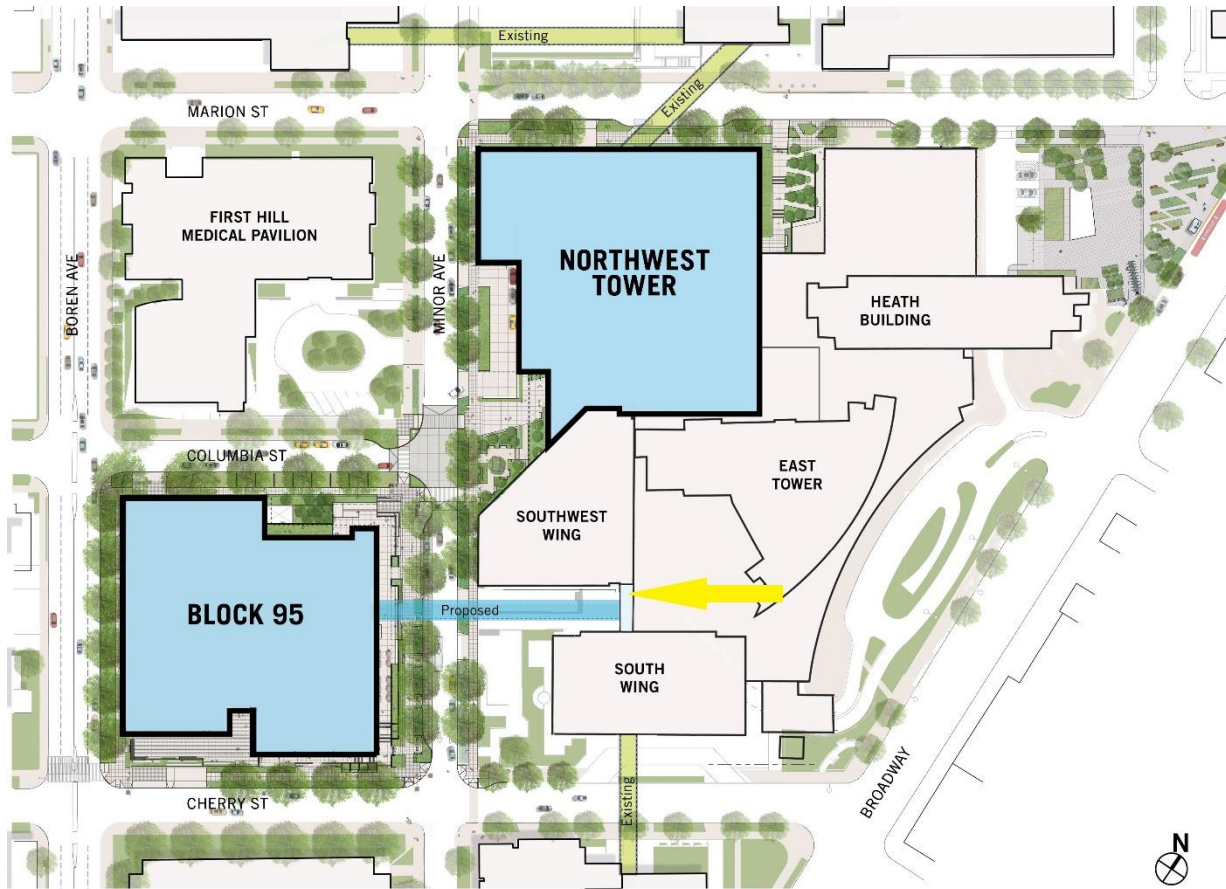

# Swedish Minor Skybridge

## PUBLIC BENEFITS SUMMARY

### MINOR AVE SKYBRIDGE

- 1 Minor Ave Garden
- 2 Public Art - Minor Ave Garden
- 3 Public Art - Skybridge
- 4 Minor & Columbia Raised Intersection
- 5 Minor Ave ROW Enhancements

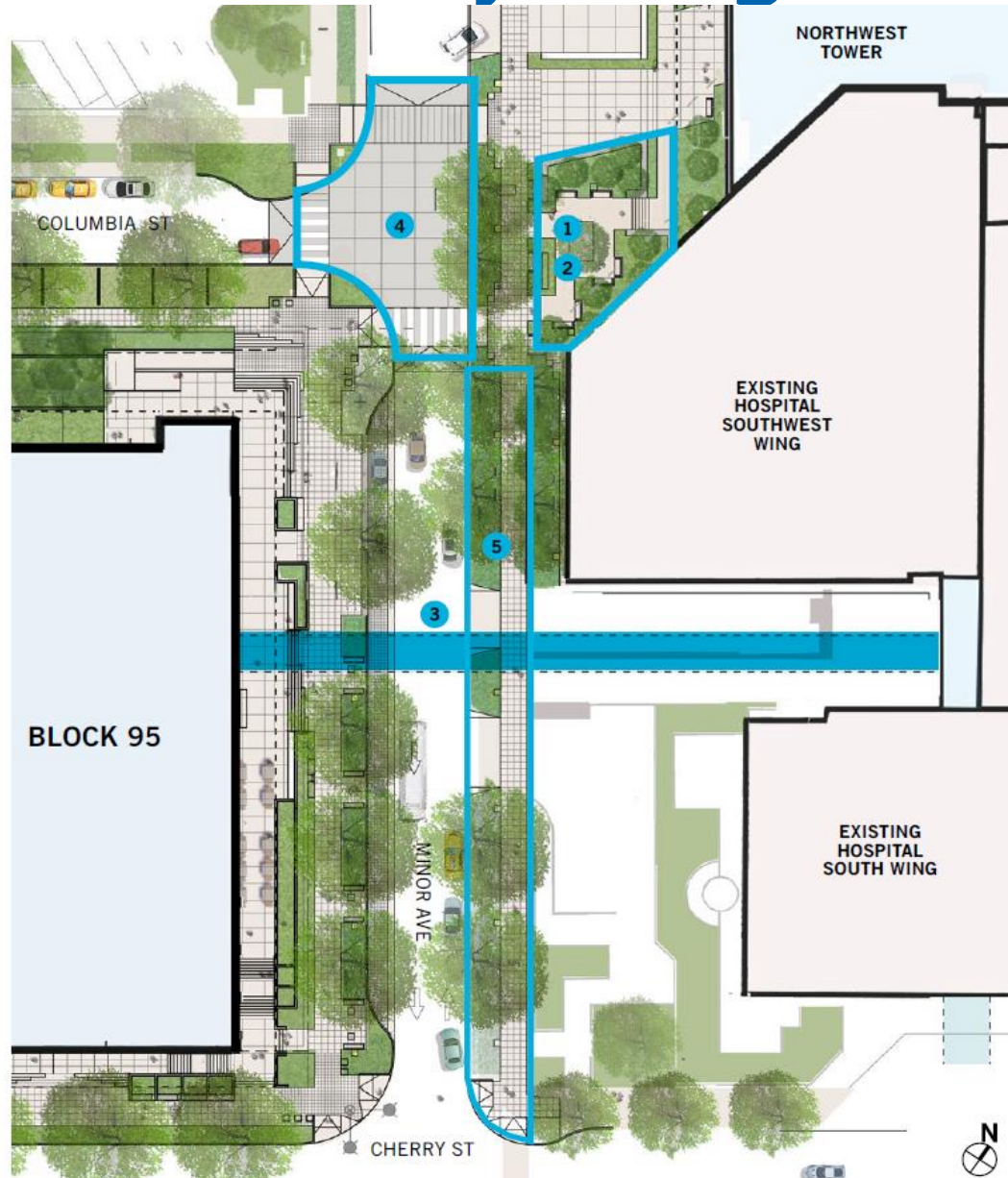

# Public Benefit Mitigation

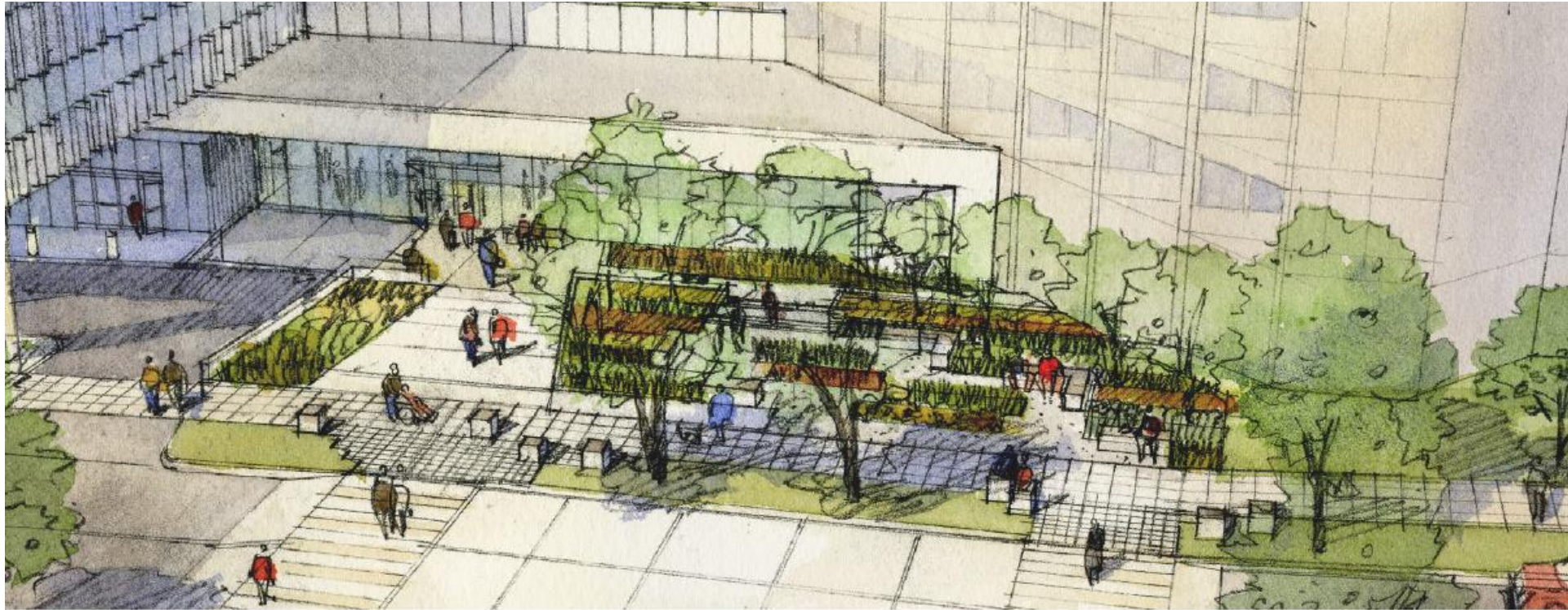

## PUBLIC BENEFIT SUMMARY

- 3,200 SF of Open Space
- \$150K Public Art Budget
- Universal access from Minor Ave
- Highly visible, safe and secure garden setting
- Seating with views west towards downtown
- Artwork to be curated with outdoor sculpture from Northwest Artists

# Public Benefit Mitigation

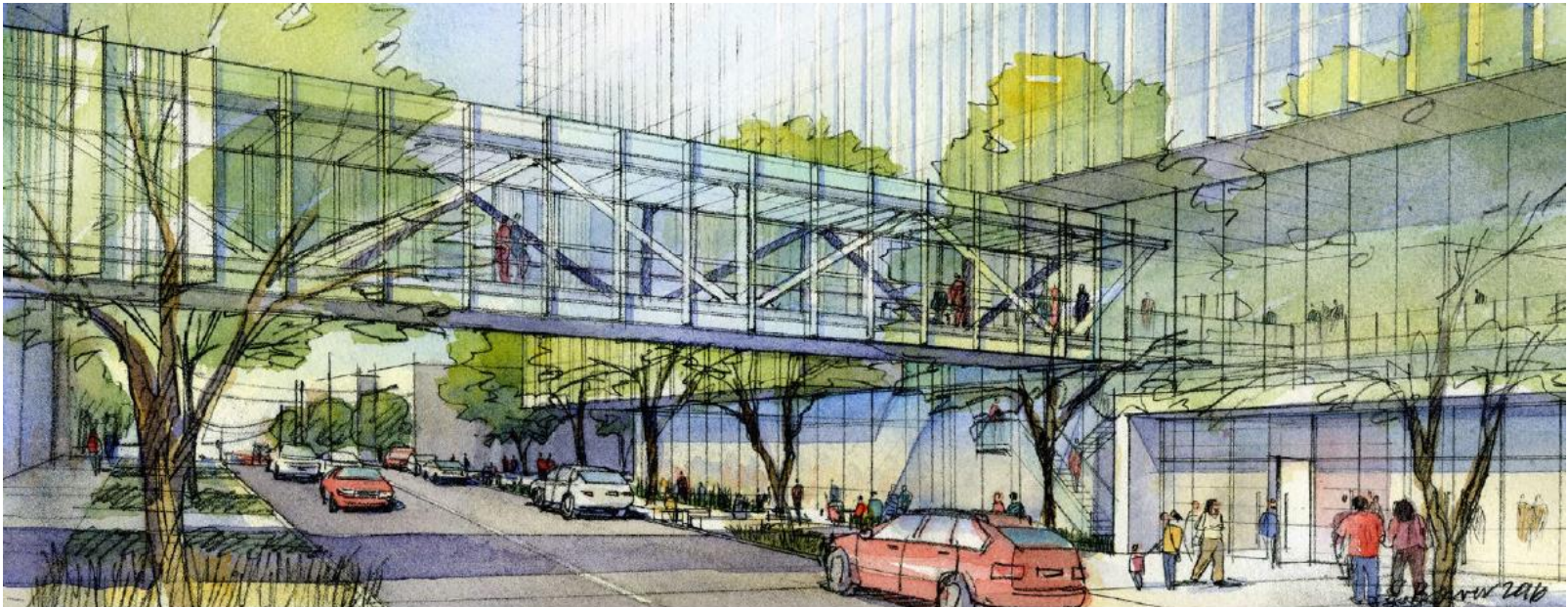

## PUBLIC BENEFIT SUMMARY

- \$350K Public Art Budget to collaborate with the design team on the skybridge



## PUBLIC ARTIST: CLAUDE ZERVAS

- Multi-disciplinary artist who lives and works in Seattle
- Methodologies include painting, video and electronic sculpture
- Successful gallery practice and several public art commissions
- Most recent public commission completed this year at Western Washington University

# Public Benefit Mitigation



## **PUBLIC BENEFIT SUMMARY**

- 3,400 SF of Raised Concrete Intersection

- A 3" raised intersection at Columbia St and Minor Ave
- The intersection has 60% SIP approval from SDOT
- Enhanced experience without degrading traffic movement

# Public Benefit Mitigation

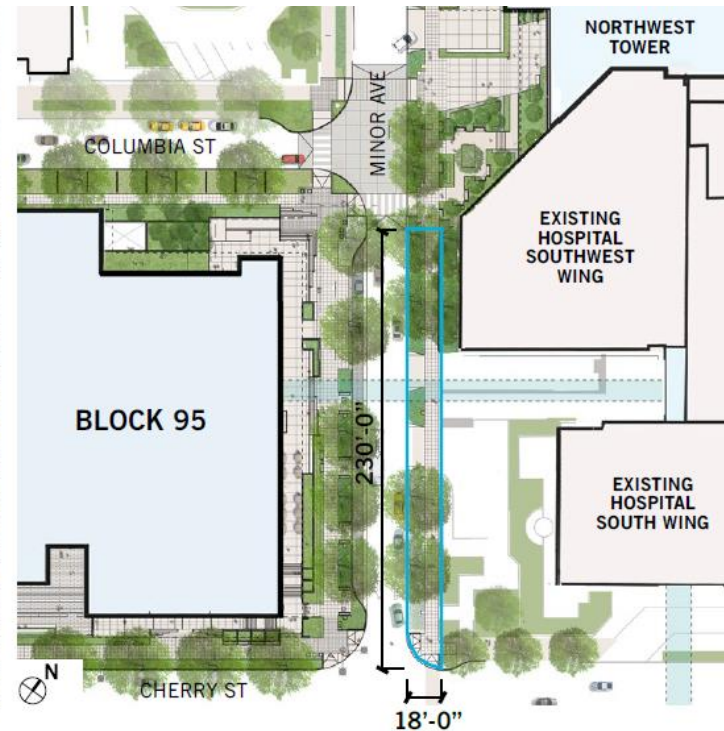

## PUBLIC BENEFIT SUMMARY

- 4,100 SF of Open Space
- Pedestrian Lights
- Street paving, curb, sidewalk, curb ramps, street trees, and planting



# Public Benefit Mitigation Summary

PUBLIC BENEFIT	DESCRIPTION	CODE REQUIRED	MIMP REQUIRED	QUANTITY	COST
1 MINOR AVENUE GARDEN	3,200 sf of publicly accessible open space directly adjacent to Minor Avenue <ul style="list-style-type: none"> <li>• 1,500 SF of planting area</li> <li>• 11 LF of seating elements</li> <li>• Landscape pedestrian lighting to 1/2 FC</li> <li>• 8 trees</li> </ul>	None	None	3,200 SF	\$230,000
2 PUBLICLY ACCESSIBLE ART - MINOR AVENUE GARDEN	Curated outdoor sculpture collection located in Minor Avenue Garden	None	None	Art Program Budget	\$150,000
3 PUBLICLY ACCESSIBLE ART - MINOR AVENUE SKYBRIDGE	Work with selected artist on significant artwork element on Minor Avenue Skybridge	None	None	Art Program Budget	\$350,000
4 MINOR AND COLUMBIA INTERSECTION	Intersection and sidewalk improvements to enhance pedestrian safety	None	None	3,400 SF	\$250,000
5 MINOR AVENUE ENHANCED ROW	Expanded pedestrian streetscape, including street paving, curb, sidewalk and curb ramps, street trees, planting, and pedestrian lights	None	None	3,700 SF	\$240,000
<b>TOTAL</b>					<b>\$1,220,000</b>

# Action requested:

- Review term permit legislation
- Recommend approval of Swedish's skybridge term permit application

# Questions?

amy.gray@seattle.gov | (206) 386-4638

[http://www.seattle.gov/transportation/stuse\\_home.htm](http://www.seattle.gov/transportation/stuse_home.htm)

<http://www.seattle.gov/transportation>

