

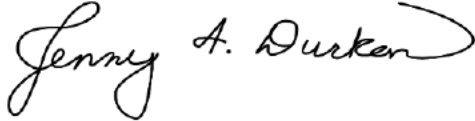



City of Seattle Boards & Commissions Notice of Appointment

Appointee Name: Michael R. Cannon		
Board/Commission Name: East Design Review Board		Position Title: Local Residential Representative
<input checked="" type="checkbox"/> Appointment OR <input type="checkbox"/> Reappointment		Council Confirmation required? <input checked="" type="checkbox"/> Yes <input type="checkbox"/> No
Appointing Authority: <input type="checkbox"/> Council <input type="checkbox"/> Mayor <input checked="" type="checkbox"/> Other: Joint Mayor & Council	Date Appointed: 4/8/2021	Term of Position: * 4/4/2021 to 4/3/2023 <input type="checkbox"/> Serving remaining term of a vacant position
Residential Neighborhood: Capitol Hill	Zip Code: 98112	Contact Phone No.: <div style="background-color: black; width: 100px; height: 15px;"></div>
Background: <p>Mr. Cannon is an Urban Designer and a Licensed Landscape Architect with over 30 years of international and domestic experience. He is currently a Senior Associate at VIA Architecture where his work includes providing design leadership on landscape, site planning, and urban design projects. Prior to VIA, he was the Landscape Architecture Director at CIVITAS Urban Design & Planning in Vancouver BC, and a senior Associate and Landscape Architect in various firms in different west coast cities.</p> <p>Much of Mr. Cannon’s work focuses on public space design, such as TOD projects, streetscape design, design guidelines, large-scale master plans, and campus planning. He additionally mentors junior staff and has project management experience.</p> <p>Mr. Cannon earned a Bachelor of Landscape Architecture degree from the University of Oregon followed by a Master of Urban Planning and a Certificate in Urban Design from the University of Washington.</p>		
Authorizing Signature (original signature): 	Appointing Signatory: Jenny A. Durkan Mayor of Seattle	
Authorizing Signature (original signature): 	Appointing Signatory: Dan Strauss City Councilmember	

*Term begin and end date is fixed and tied to the position and not appointment date.



MICHAEL R. CANNON, ASLA
LANDSCAPE ARCHITECTURE & URBAN DESIGN

EDUCATION

University of Washington
Master of Urban Planning, 1993
Certificate in Urban Design, 1993

University of Oregon
Bachelor of Landscape Architecture, 1987

PROFESSIONAL REGISTRATION

Licensed Landscape Architect, California, Oregon,
and Washington

HONORS & AWARDS

Merit Award, *Currie Barracks*, Calgary, Congress
of New Urbanism (CNU), CIVITAS, 2016.

Honorable Mention, The Mawson Urban Design
Award, *Currie Barracks*, CIVITAS, 2015.

AIA NEXT Awards, *Four Seasons Resort /
Hamyang Master Plan*, South Korea, Los Angeles
CA Chapter, NBBJ, 2009.

Oregano Fellowship, NBBJ, 2007

International Competition, 1st Place, *Shanghai
American School & New Community*, NBBJ, 2006

ASLA Design Merit Award, California Chapter,
Mission Creek Park, EDAW, 2004

ASLA Design Merit Award, Colorado Chapter,
Zellerbach Garden, San Francisco, EDAW, 2004

ASLA National Merit Award, *Jinji Lake Master Plan*,
EDAW, 2004

Best Built Project Award, The Waterfront Center,
Jinji Lake Grand Promenade, Suzhou, China,
EDAW, 2003

Kenneth Brown Asia Pacific Culture &
Architecture Award, *The Jinji Lake Waterfront*,
EDAW, 2003

Golden Nugget Award, Best Master Planned
Community, *Wingfield Springs*, EDAW, Nevada
1996

Meyer R. Wolf Scholar in Urban Design,
University of Washington, 1993

AFFILIATIONS

American Society of Landscape Architects (ASLA)
American Planning Association (APA)
Congress of New Urbanism (CNU)

PROFILE

Award winning Landscape Architect and Urban Designer with over 30 years of international and domestic experience. Versatile and experienced designer, comfortable working at various scales with multi-disciplinary teams on complex and demanding projects. Design approach employs thoughtful rigor with creative vision, a hardworking team player and believes in an integrated approach to design, balancing project and client demands to create inspired, transformational and sustainable environments.

PROFESSIONAL EXPERIENCE

VIA Architecture, Seattle, WA | Senior Associate, 2017 - Current

Responsibilities include providing design leadership on landscape, planning and urban design projects; streetscape and public realm projects, site and TOD planning, design guidelines, business development, project management, and mentoring junior staff. Significant projects include:

Burrard Station Plaza Design, Vancouver, BC Canada
Pattullo Bridge Urban Integration & Site Design, New Westminster, BC Canada
Tacoma Urban Design Guidelines, Tacoma, WA
The Heights Subarea & Master Plan, Vancouver, WA

CIVITAS Urban Design & Planning, Vancouver, BC Canada | LA Director, 2011 - 2017

Responsibilities include providing design leadership on large scale master plans and urban design projects; site planning and landscape architecture, public realm design, campus planning, mentoring junior staff. Significant projects include:

Northeast False Creek Urban Design Plan, Vancouver, BC
Rouse Hill Phase 2 Urban Design Plan, Sydney, Australia
Alexandra Park Master Plan & Phase One Design, Auckland, New Zealand
Australian National University Campus Master Plan, Canberra, Australia

NBBJ, Seattle WA | Senior Associate 2005 - 2010

Senior landscape architect and urban designer, responsible for project site design and urban planning of studio projects. Provided a landscape design and site planning leadership role, working collaboratively with multidisciplinary teams responsible for delivering work on an international and domestic scale. Significant projects included:

University Medical Center, LSU, New Orleans, LA
Veterans Administration Hospital, New Orleans, LA
Microsoft Redmond West Campus, Redmond, WA
The Spring District Master Plan, Bellevue, WA,

EDAW, Seattle, WA | Senior Associate 2003 - 2005

Senior landscape architect and urban designer for domestic and international projects. Responsibilities included design studio leadership, project management, business development, mentoring junior staff, co-management of design studio, and collaborating with other EDAW offices. Significant projects included:

Placer Vineyards Master Plan, Sacramento, CA,
Las Campanas Resort Community, Santa Fe, NM;
Chambers Creek Golf Course, Tacoma, WA
Seattle Waterfront Competition, Seattle, WA

EDAW San Francisco, CA | Senior Associate 1994 - 2003

TECHNICAL SKILLS

Adobe Photoshop, InDesign, SketchUp, Powerpoint, Microsoft Word, Excel, etc.

REFERENCES

Steve McConnell, AIA
Managing Partner, Design, NBBJ Seattle

Jim Heid, FASLA
Urban Green, San Francisco, CA

Jacinta McCann, ASLA
Senior Vice President, AECOM San Francisco

Joe Hruda, MAIBC
Founder, CIVITAS Urban Design & Planning
Vancouver, BC

Landscape architect and project manager for numerous domestic and international projects, including a SF Design Studio co-leadership role. Responsibilities included providing design leadership on significant landscape and urban design projects from schematic through construction documents; mentoring junior staff, and marketing.

Significant projects included:

Jinji Lake Waterfront Master Plan & Phase 1 Development, Suzhou, China
Mission Creek Park, San Francisco, CA
Hualalai Four Seasons Resort Master Plan, Kona, HI
Upper Truckee River & Wetlands Restoration, South Lake Tahoe, CA

Murase Associates, Seattle, WA & Portland, OR | Landscape Architect 1987 - 1994
Responsible for landscape concept, schematic, design development, and construction documents of project site work, including cost estimates, material selection, specifications, and schematic illustrations. Significant projects included:

Port of Seattle Headquarters, Pier 69, Seattle, WA
University of Washington Physics Building, Seattle, WA
University of Washington Chemistry Building, Seattle,
Oregon Convention Center, Portland, OR
Japanese American Memorial Plaza, Portland, OR

PROJECT WORK



BURRARD STATION PLAZA, Vancouver BC Canada 2020-2021
URBAN DESIGNER / LANDSCAPE ARCHITECT

Burrard Station, located in Coal Harbor in downtown Vancouver, will be undergoing a significant transformation in order to serve a dramatic future projected increase in transit ridership. Upgrading the station requires a significant redesign of the current plaza, which as part of Art Phillips Park along Dunsmuir Street involves seamlessly connecting bus and train passenger flows and creating a dynamic new urban space for Vancouver. Role: design lead, plaza and landscape architecture, coordination of PWL as landscape subconsultant.



CONFIDENTIAL MASTER PLAN & URBAN DESIGN GUIDELINES, Near Damascus, Syria 2013
URBAN DESIGNER / LANDSCAPE ARCHITECT

Provided design leadership role working with dedicated team of architects and planners for the layout of a new city core and urban residential neighborhoods. The project involved planning and design of over a square kilometer of new districts with mixed use, commercial, retail, residential, entertainment, parks and open space uses. Required design of numerous development options and video presentations to client as well as participating in CIVITAS-lead workshops. Role: Lead designer, landscape and public realm, and urban design guidelines.



ALEXANDRA PARK, Auckland, New Zealand 2014 - 2016
URBAN DESIGNER / LANDSCAPE ARCHITECT

Located 5 Kilometres from downtown Auckland, Alexandra Park is an aging racecourse site on which CIVITAS has planned a vibrant new urban mixed use neighborhood. The larger master plan features a significant central park recalling the historic racing legacy, and integrates needed urban density to the surrounding single family neighborhoods. Phase One, currently under construction, includes a new vertical mixed use retail street, complete with urban parks, plazas, and squares in an enhanced public realm while maintaining the racecourse operations and grandstand. Role: Lead designer, landscape and public realm.

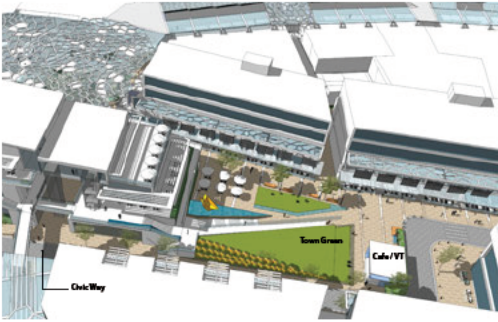

ROUSE HILL TOWN CENTRE, Rouse Hill, Australia 2011 - 2016
LANDSCAPE ARCHITECT / URBAN DESIGNER

Phase 2 of this ULI Award winning project is currently being planned by CIVITAS, and will feature transit oriented development (TOD) density with mixed use neighborhoods, retail shopping, educational facilities, healthcare, entertainment, commercial, civic facilities, and an extensive public realm. A new heavy rail line will link Rouse Hill to Sydney, thereby providing a significant influx of visitors, future residents, and development opportunity. Role: master planning, site design, public realm, landscape architecture, and project management.



CURRIE BARRACKS, Calgary, Alberta Canada 2014 - 2015
URBAN DESIGNER / LANDSCAPE ARCHITECT

The redevelopment of the 165-acre former barracks just south of downtown Calgary preserves historic buildings and military landscapes like the former parade grounds. The plan provides for a higher density urban mixed use core, which CIVITAS redesigned over a six month period working within a larger master plan framework. Role: Design lead, landscape and public realm.



UNIVERSITY MEDICAL CENTER, New Orleans, Louisiana 2009 - 2010
LANDSCAPE ARCHITECT

Lead the site design and landscape architecture for this complex 30-acre campus in New Orleans, LA, working with local landscape architects, civil engineers, and NBBJ's healthcare team. The \$33 million campus site program included a major public plaza on Canal Street, a series of waterfeatures, gardens and courtyards to assist in the healing of patients. The project involved coordination with adjacent new VA hospital, integration with the existing LSU campus, and developing a conceptual framework for landscape architecture in a healthcare setting of post-Katrina New Orleans. Role: Lead design, landscape.



VETERANS ADMINISTRATION HOSPITAL, New Orleans, LA 2009
LANDSCAPE ARCHITECT

Developed the overall site framework and produced the landscape design working closely with a team of NBBJ architects for the VA's new 30-acre campus in New Orleans, from initial stages of Programming through Schematic Design. The site program included establishing integrated safeguards against future potential flooding and terrorism, including the use of site walls and terraces to gracefully transition the building to the streetscape. The plan involved designing a series of New Orleans-inspired courtyards and gardens for veteran patients and visitors, and meeting the challenge of incorporating this large campus into the local neighborhood fabric of New Orleans. Role: Landscape Concept & Schematic Design



THE JINJI LAKE MASTER PLAN & PHASE ONE DEVELOPMENT, Suzhou, China 2000 - 2004
LANDSCAPE ARCHITECT

Landscape Architect of the overall 550 hectare Master Plan and Phase One Plan for an international residential and business community projected to be over 600,000 residents. Worked with a team of designers and planners while at EDAW to create several miles of sensitive waterfront development to maintain the water quality of Jinji Lake for future generations. Project included master planning of waterfront development parcels, and the design of significant parks, streets, recreation areas and open spaces to serve this large future population. This project was one of five special development zones intended to integrate the technology industry to the interior of China.

Seattle Design Review Boards - March 2021

42 Design Review Board Members: Pursuant to SMC 23.41.008, *all* members are subject to City Council confirmation, *two-year* terms that may be re-appointed to a second term:

- 12 City Council-appointed
- 13 Mayor-appointed
- 15 Joint Mayor and Council appointed
- 2 *Mayor appointed per SMC 3.51 (Get Engaged)*

Roster:

*D	**G	RD	Position No.	Position Title	Name	Term Begin Date	Term End Date	Term #	Appointed By
6	M		1.	Local Residential, DT	Bissen, Matthew	4/4/2021	4/3/2023	1	Mayor/Council
3	M		2.	Local Community, NE	Castaneda, Manuel	4/4/2021	4/3/2023	1	Mayor
6	M		3.	Development, SW	Rosenstock, Scott	4/4/2020	4/3/2022	2	Mayor
6	F		4.	Business/Landscape, W	Montessor, Jen	4/4/2021	4/3/2023	2	Mayor/Council
6	F		5.	Local Residential, SW	Lirman, Johanna	4/4/2021	4/3/2023	1	Mayor
6	F		6.	Business/Landscape, E	van Geldern, Emily	4/4/2020	4/3/2022	1	Mayor/Council
9	M		7.	Local Community, SE	Colley, Chris	4/4/2020	4/3/2022	2	Mayor
6	M		8.	Development, SE	Germain, Stewart	4/4/2020	4/3/2022	1	Council
6	M		9.	Local Community, NW	Johnson, Brian	4/4/2020	4/3/2022	1	Council
6	F		10.	Local Business, NW	Bogert, Phoebe Erin	4/4/2021	4/3/2023	2	Mayor/Council
6	F		11.	Design Professional, E	Gage, Gina	4/4/2021	4/3/2023	1	Mayor
6	M		12.	Development, NW	Dijulio, Penn	4/4/2020	4/3/2022	1	Mayor
6	M		13.	Business/Landscape, DT	Luoma, Aaron	4/4/2020	4/3/2022	2	Mayor/Council
6	M		14.	Development, E	Bendix, Chris	4/4/2021	4/3/2023	1	Council
6	M		15.	Development, NE	Gunter, Christian	4/4/2020	4/3/2022	1	Council
1	M		16.	Local Community, SW	Cheng, John	4/4/2020	4/3/2022	2	Council
6	M		17.	Design Professional, NE	Rusler, Dan	4/4/2020	4/3/2022	2	Council
6	F		18.	Design Professional, W	Eckrich, Janell T.	4/4/2021	4/3/2023	1	Council
6	M		19.	Local Community, W	Morefield, John	4/4/2020	4/3/2022	2	Mayor
6	F		20.	Development, DT	Dagliano, Carey	4/4/2021	4/3/2023	1	Council
6	M		21.	Business/Landscape, SW	Cobb, Patrick	4/4/2021	4/3/2023	1	Mayor/Council
1	F		22.	Design Professional, SE	So, May	4/4/2021	4/3/2023	2	Council
9	F		23.	Design Professional, NW	Watkins, Adrienne	4/4/2021	4/3/2023	1	Mayor

6	M		24.	Local Community, E	Haas, Andrew	4/4/2021	4/3/2022	2	Council
6	F		25.	Local Residential, NW	Rock, Lauren	4/4/2020	4/3/2022	2	Mayor/Council
6	M		26.	Local Community, DT	Henderson, Jason	4/4/2020	4/3/2022	1	Mayor
6	F		27.	Development, W	Ratray, Tiffany	4/4/2021	4/3/2023	1	Mayor
6	M		28.	Local Residential, NE	Carter, Timothy	4/4/2021	4/3/2023	2	Mayor/Council
6	M		29.	Design Professional, DT	Palushock, Ed	4/4/2020	4/3/2022	2	Mayor
6	M		30.	Design Professional, SW	Grainger, Alan	4/4/2021	4/3/2023	2	Mayor/Council
6	M		31.	Business/Landscape, SE	Bader, David	4/4/2020	4/3/2022	2	Mayor/Council
6	M		32.	Local Residential, W	Farkas, Allan	4/4/2021	4/3/2023	1	Mayor/Council
6	M		33.	Local Residential, E	Cannon, Michael R.	4/4/3021	4/3/2023	1	Mayor/Council
6	M		34.	Local Residential, SE	Maier, Daniel	4/4/2021	4/3/2023	2	Mayor/Council
6	F		35.	Business/Landscape, NE	Liss, Katharine	4/4/2020	4/3/2022	1	Mayor/Council
6	F		36.	Get Engaged	Honig, Margaret	9/1/2020	8/31/2021	1	Mayor (SMC 3.51)
5	F		37.	Local Residential, CA	Khosla, Sharon	4/4/2020	4/3/2022	2	Council
2	F		38.	Local Community, CA	Ingram, Ronquesha	4/4/2020	4/3/2022	1	Mayor
6	M		39.	Design Professional, CA	Floor, Jeffrey	4/4/2020	4/3/2022	2	Council
2	M		40.	Development, CA	Pleasant, Kenny	4/4/2020	4/3/2022	2	Mayor
3	F		41.	Business/Landscape, CA	Garcia, Ana Cristina	4/4/2020	4/3/2022	1	Mayor/Council
6	M		42.	Get Engaged	Stein, Connor	9/1/2020	8/31/2021	1	Mayor (SMC 3.51)

New Appointments

Re-appointments

Vacant

SELF-IDENTIFIED DIVERSITY CHART					(1)	(2)	(3)	(4)	(5)	(6)	(7)	(8)	(9)
	Men	Women	Transgender	Unknown	Asian	Black/ African American	Hispanic/ Latino	American Indian/ Alaska Native	Other	Caucasian/ Non- Hispanic	Pacific Islander	Middle Eastern	Multiracial
Mayor	9	6	0	0	0	2	1	0	0	10	0	0	2
Council	8	4	0	0	2	0	0	0	1	9	0	0	0
Joint	9	6	0	0	0	0	1	0	0	14	0	0	0
Total	26	16	0	0	2	2	2	0	1	33	0	0	2

Key:

***D** List the corresponding *Diversity Chart* number (1 through 9)

****G** List *gender*, M = Male, F= Female, T= Transgender, U= Unknown

RD Residential Council District number 1 through 7 or N/A

Diversity information is self-identified and is voluntary.