



OFFICE OF THE WATERFRONT

February 4, 2016

PARKS, SEATTLE CENTER, LIBRARIES, AND WATERFRONT
COMMITTEE

TODAY'S AGENDA



- Waterfront Seattle overview
- 2015 accomplishments
- 2016 work plan priorities
 - Updated plans for Main Corridor, Overlook Walk, Pier 62/63
 - Utility relocations
 - Environmental review
 - City/State funding agreement
 - Public engagement
 - Coordination with partners



ELLIOTT BAY

Elliott Bay Seawall Project
Phase 2

Elliott Bay Seawall Project
Phase 1 (2013-2017)

Seattle Multimodal Terminal
at Colman Dock Project
(2017-2022)

Waterfront Seattle
Phase 1 (2019+)

SR 99 Tunnel Project
(2011-2018)

- WATERFRONT SEATTLE PHASE 1 AREA
- ELLIOTT BAY SEAWALL PROJECT PHASE 1
- ELLIOTT BAY SEAWALL PROJECT PHASE 2
- SR 99 TUNNEL PROJECT
- SEATTLE MULTIMODAL TERMINAL AT COLMAN DOCK PROJECT
- PARTNER PROJECTS

Project construction dates are tentative and subject to change

Sources: City of Seattle GIS, Google maps, SDOT 2010 Bike Map, ROMA 2002 Urban Design Assessment



Seattle's waterfront park comes into focus

The basic outlines of the ambitious park, really four big parks connected by a promenade, are now emerging. There are very sensible design decisions being made, but can the city pull off such a spectacular plan?

By David Brewster

[Print](#) | [Email](#) | [Tweet](#) | [Like](#) 53

After all the battles over the Viaduct and the deep-bore tunnel, are we going to manage to create a splendid waterfront park for Seattle? The desire is there, and the setting is certainly spectacular. But it won't be easy, particularly given Seattle's way of building and bungling major projects.

It's now possible to get a better idea of what might happen. After the successful vote for the tunnel last month, the guardedness has been relaxed. Additionally, more details are being filled in, so the design is moving from a generic 26-block esplanade into something far more tailored to the conditions of the spaces. What follows are some of the things I learned from tagging along on a tour put together by the Seattle Parks Foundation and guided by the two principal city officials in charge, city planner Marshall Foster and



City of Seattle/James Corner Field Operations

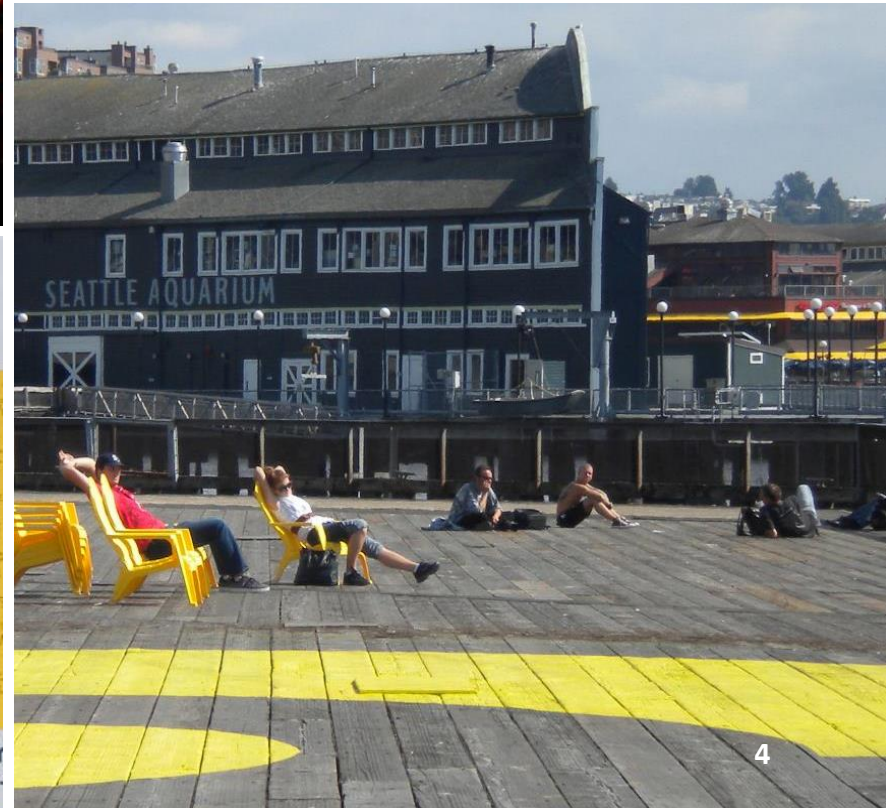

STRATEGIC PLAN



- Built on public input on Framework Plan and Concept Design
- Engaged broader business/philanthropic community in “how we get it done”
- Established public/private funding plan:
 - State and City funding
 - Philanthropy
 - Property owner assessment (LID)

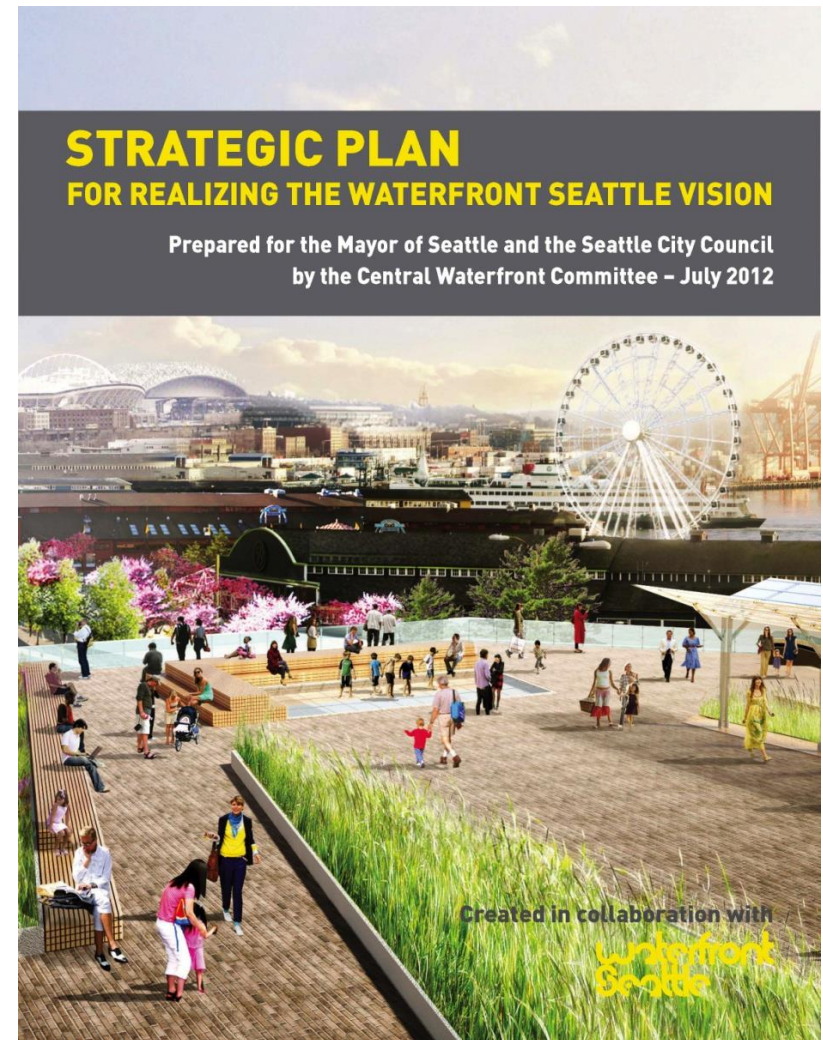

WATERFRONT SEATTLE PROGRAM

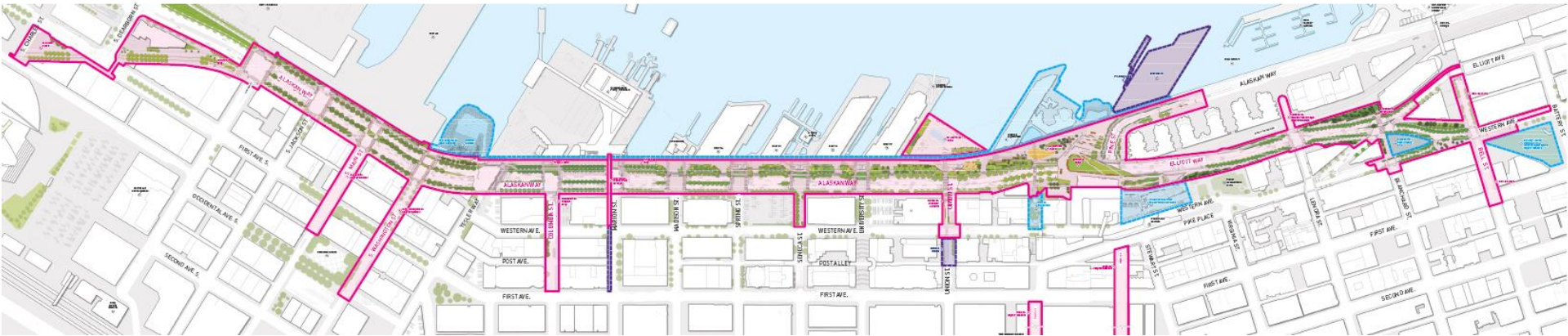

WATERFRONT PHASE 1

1. Alaskan Way + Cycle Track (south of Union)
1. Alaskan Way/Elliott Way + Cycle Track (north of Union)
2. Promenade
3. Overlook Walk
4. Marion Street Ped Bridge (Alaskan ROW to Western)
5. Columbia Streetscape
6. Seneca Restoration (WSDOT only)
7. Blanchard ROW
8. Lenora Street Bridge Improvement
9. Waterfront Park
10. Lower Union + Western Intersection
11. Pike Pine Improvements
12. Main + Washington Streets



FUTURE PHASE

1. Pier 62/63
2. Floating Dock
3. Middle Union
4. Seneca Streetscape
5. Blanchard Overlook
6. Marion Street Ped Bridge (Western to First)
7. Pool Barge



RELATED PROJECTS

- Seawall Related Elements
- Aquarium Expansion
- PC-1 / PPM Entrance
- Bell Street Improvements
- North Portal Site Park
- Pike Pine Hill Climb Improvements
- Blanchard Opportunity Site

SEAWALL

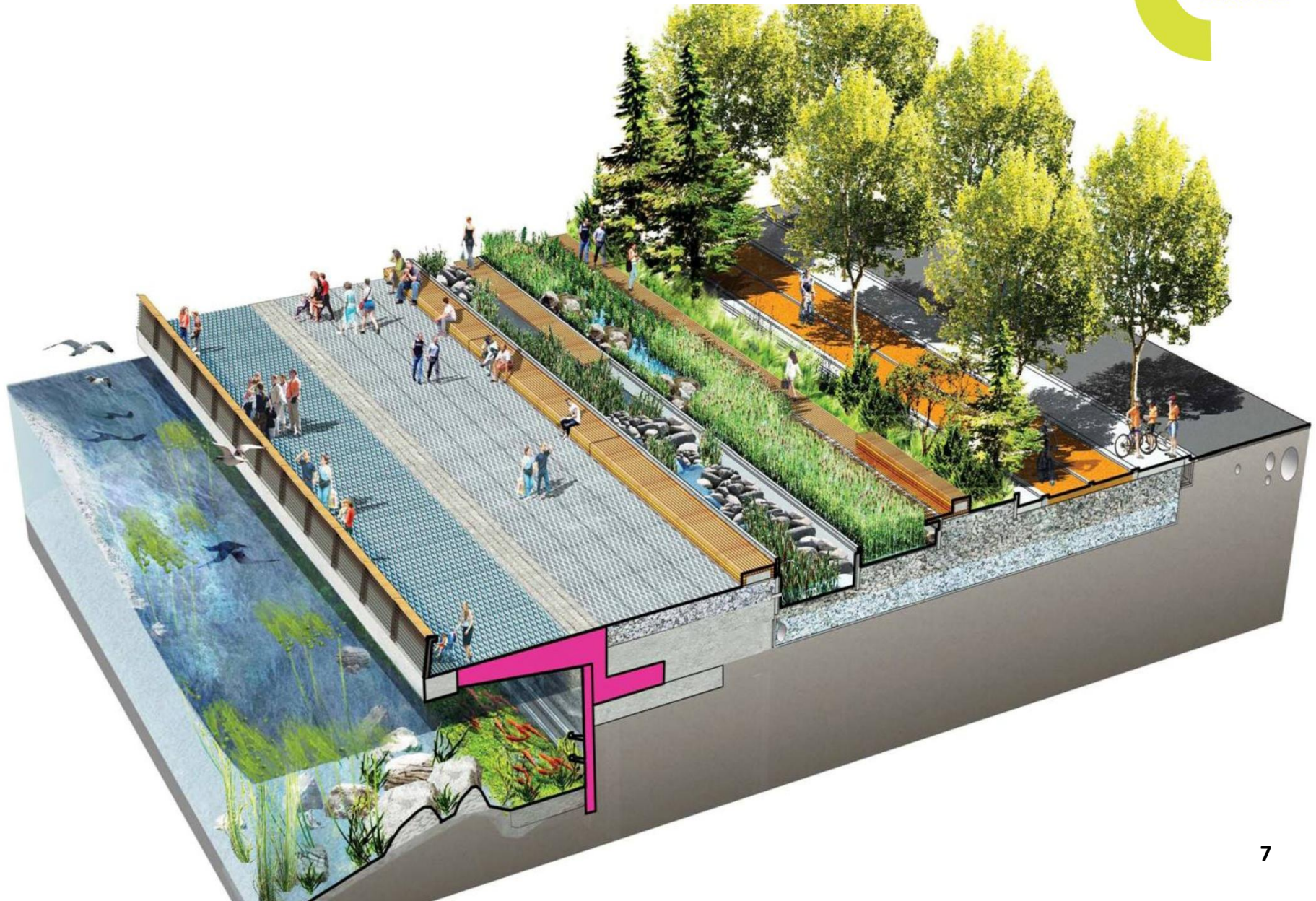





WATERFRONT 2020
HISTORIC PIERS
EXISTING CONDITIONS



WATERFRONT 2020
HISTORIC PIERS
SITE PLAN

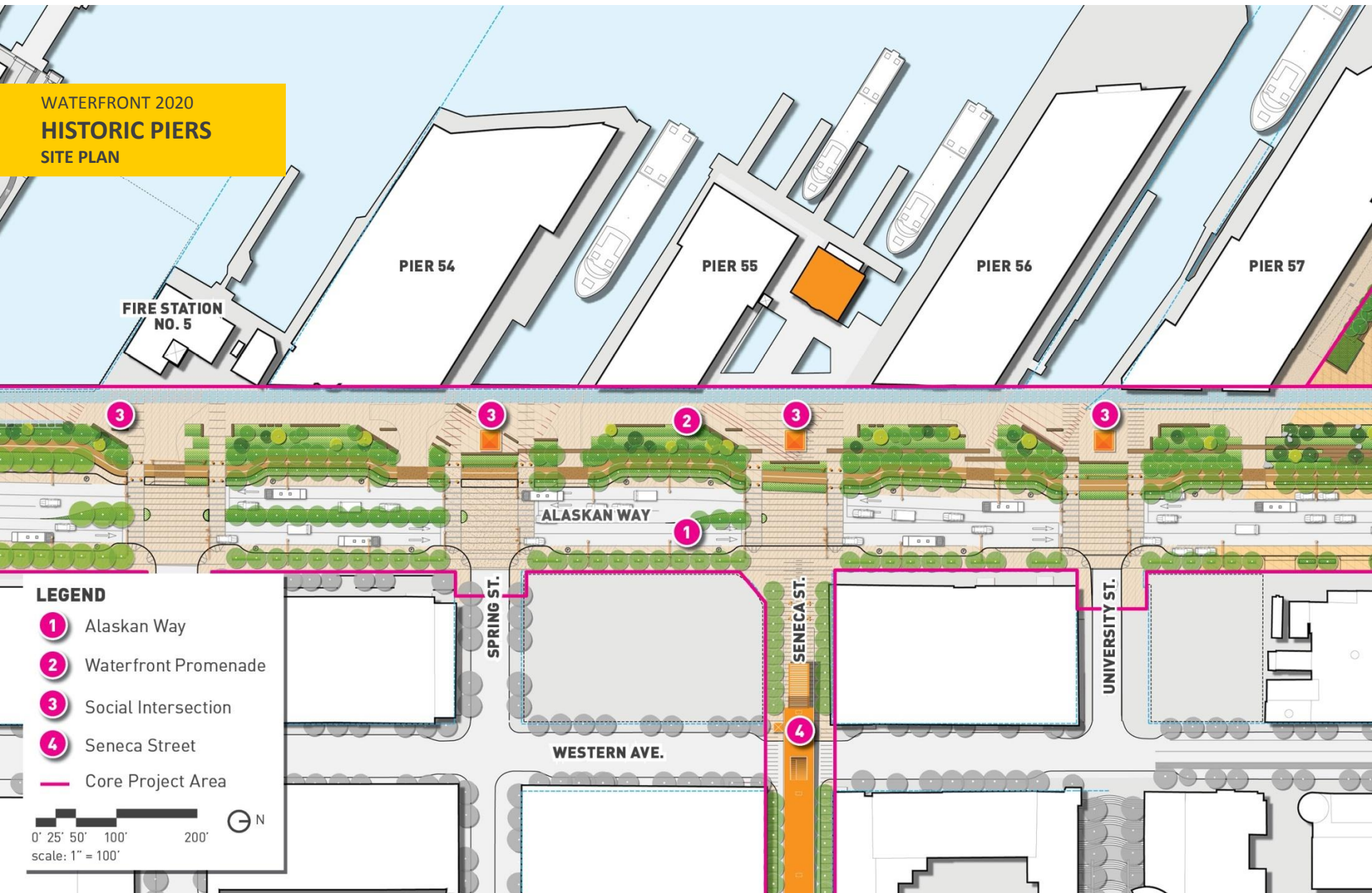

WATERFRONT 2020
HISTORIC PIERS
TIDELINE TERRACES

KEYMAP

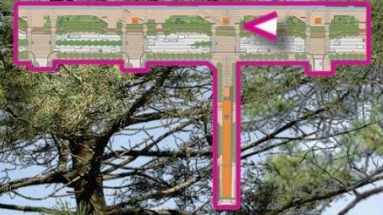

OPERATIONS AND MANAGEMENT APPROACH



1. A special management district is needed to set clear rules and expectations, enable partnerships, and do enforcement
2. Distinguish public space management areas from public right-of-way
3. The experience of Pike Place Market is a model: a public place that is well-managed, safe, and actively programmed; democratic and inclusive of all



BUDGET (2016 ADOPTED)

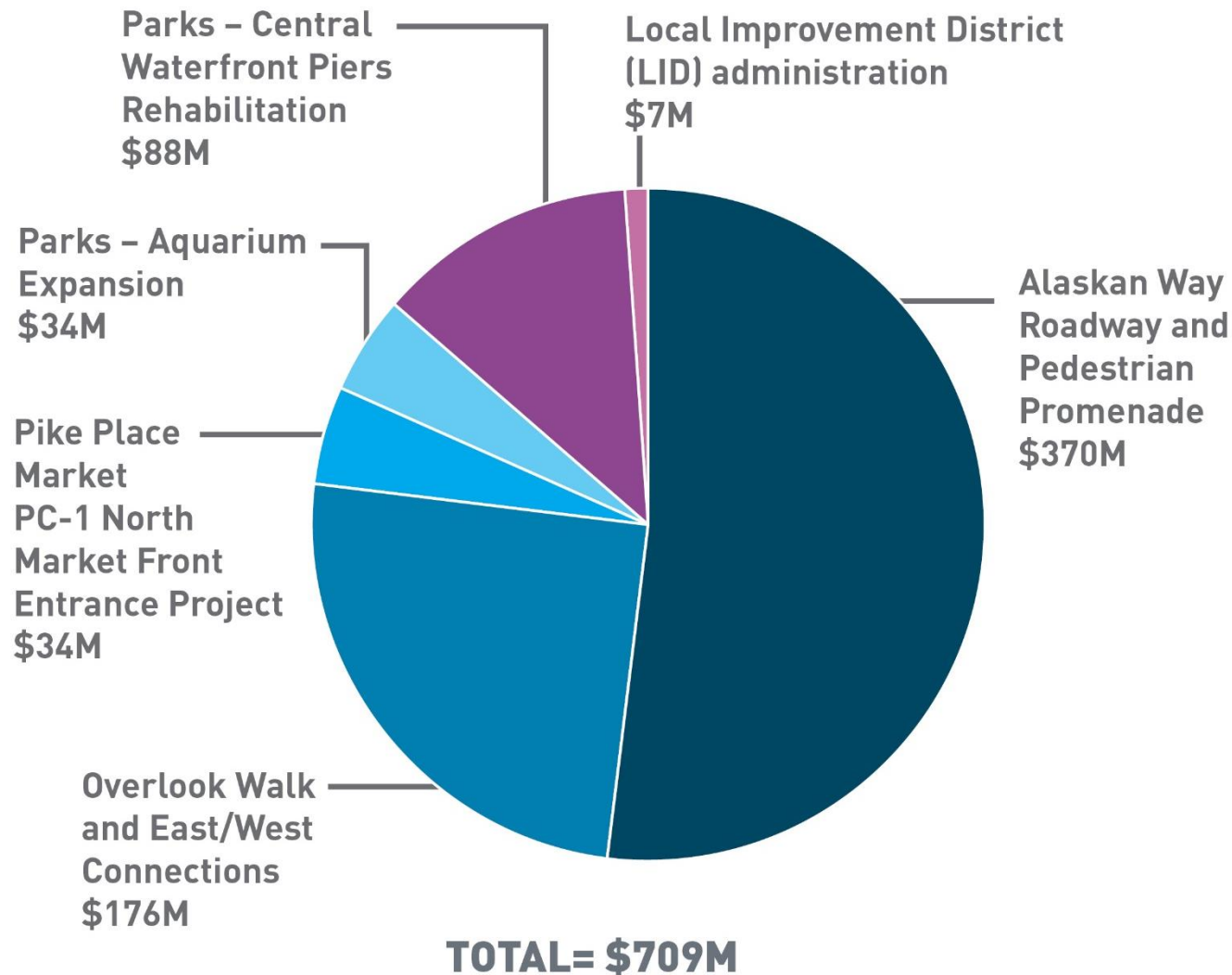

FUNDING (2016 ADOPTED)

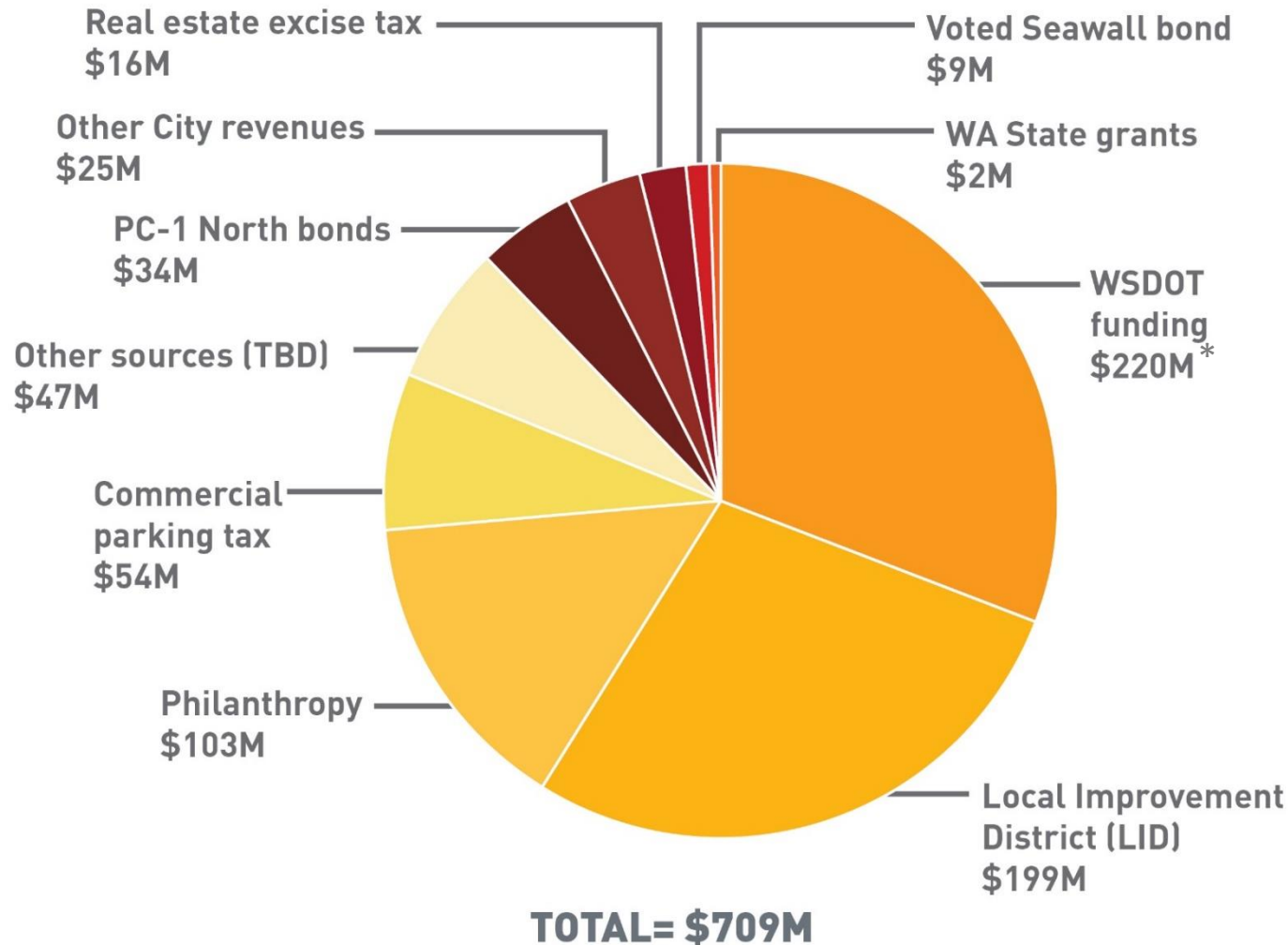

*Subject to negotiation of a construction funding agreement with WSDOT

2015 ACCOMPLISHMENTS



- Completed MarketFront (PC-1 North) Development Agreement; construction now underway
- Completed Draft Environmental Impact Statement (EIS) for Alaskan Way, Promenade and Overlook Walk
- Aquarium Master Plan approved by Council
- Practical Design Review completed, identifying a range of cost saving opportunities
- Design progress on critical utilities, including Seattle City Light and Seattle Public Utilities, telecommunications and Puget Sound Energy (natural gas)
- Maintenance Report completed
- Focused engagement with ADA community, tribes, property owners, downtown families

STAKEHOLDER ENGAGEMENT



Lighthouse for the Blind simulation tour



Senior Lunch at Filipino Community Center



Draft EIS public meeting



Waterfront Seattle photo booth at Dia de Muertos

2016 WORK PLAN PRIORITIES



- Supplemental Draft EIS for Alaskan Way, Promenade and Overlook Walk (*April*) ; Final EIS for Alaskan Way, Promenade and Overlook Walk (*fall*)
- Updated 60% plans for Main Corridor - Alaskan Way/Elliott Way (*June*)
- Cost Estimate and Validation Process (CEVP) workshop with WSDOT (*September*)
- Develop MOU with Aquarium regarding next steps for expansion (*summer*)
- Complete City/WSDOT funding agreement (*end of year*)

SCHEDULE

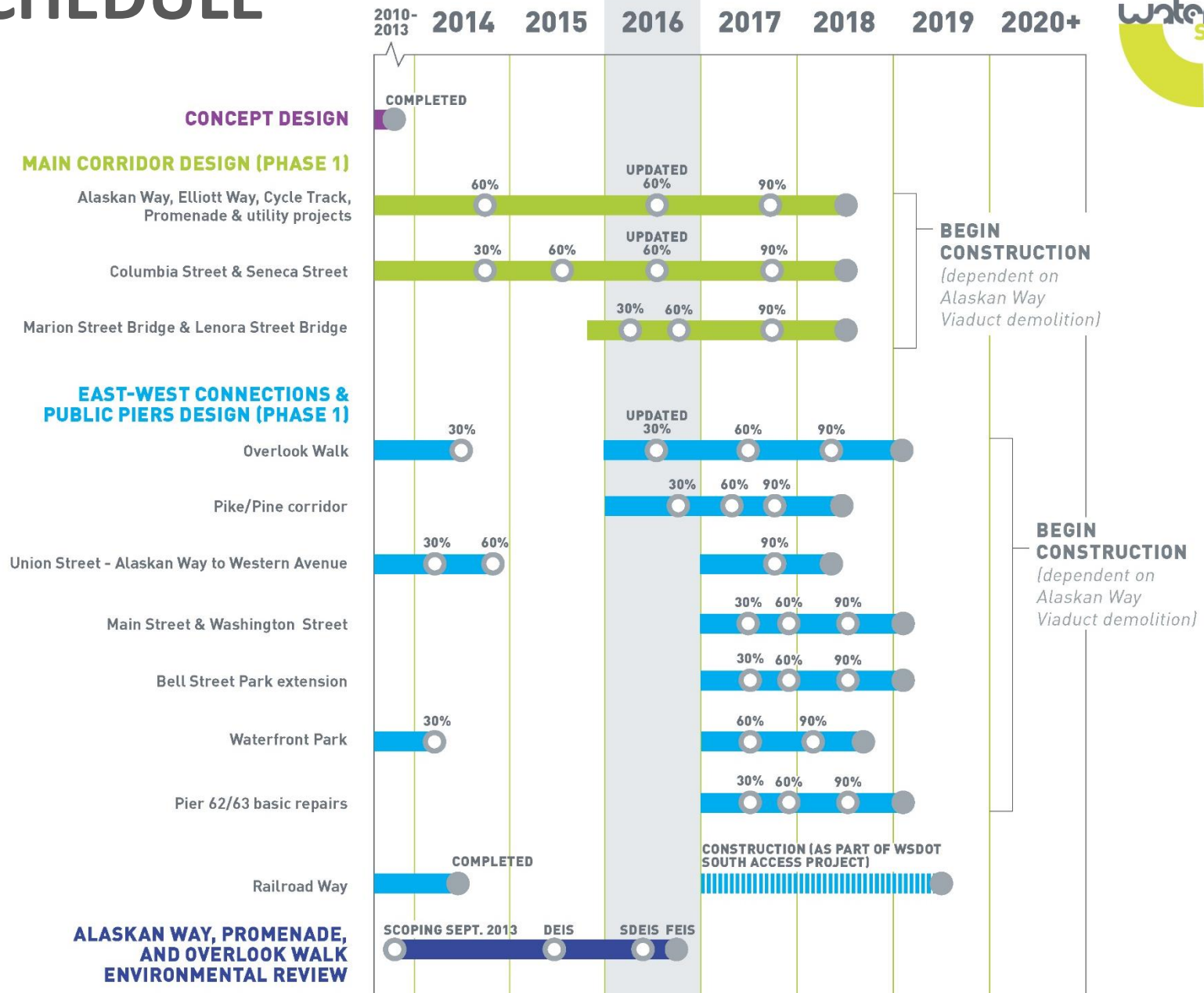

ENVIRONMENTAL REVIEW



- Supplemental Draft EIS will be completed spring 2016
- Public will have the opportunity to review and comment
- Final EIS will be published in fall 2016



UPDATED 60% PLANS – MAIN CORRIDOR

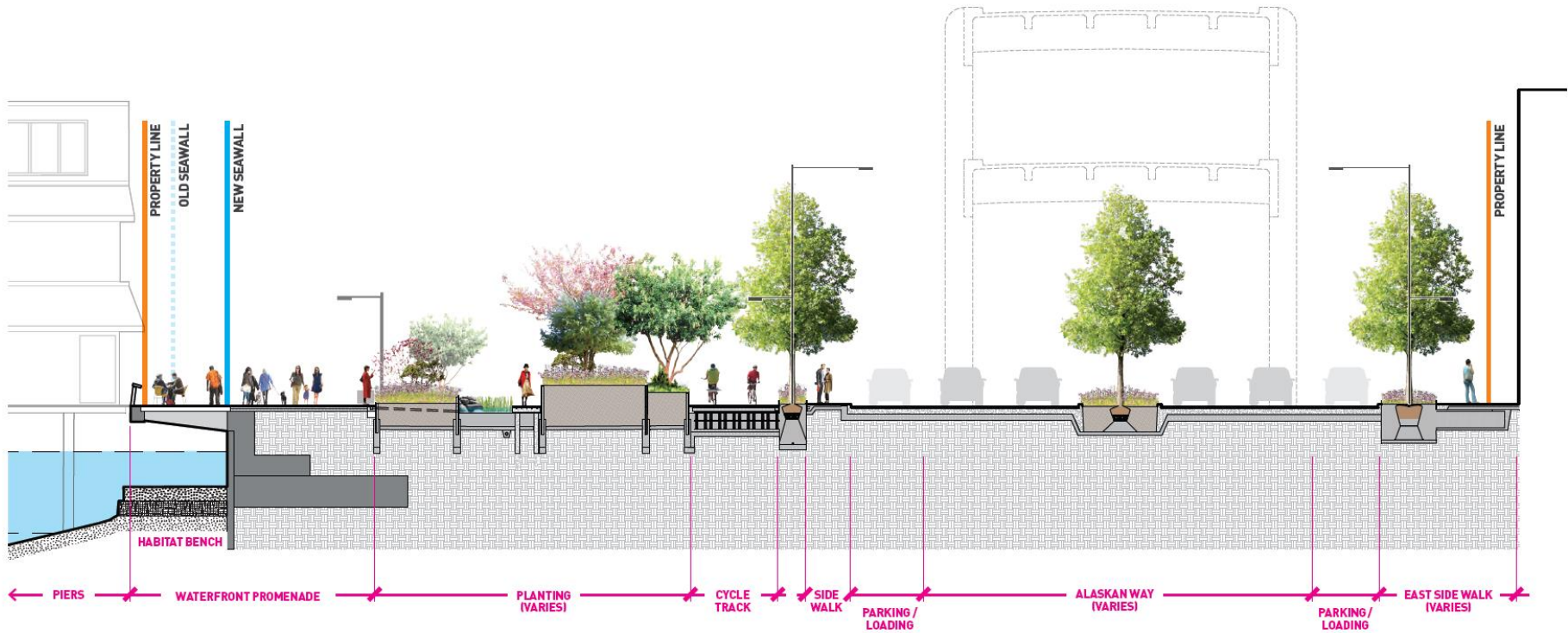

UPDATED 60% PLANS – MAIN CORRIDOR



UTILITY DESIGN

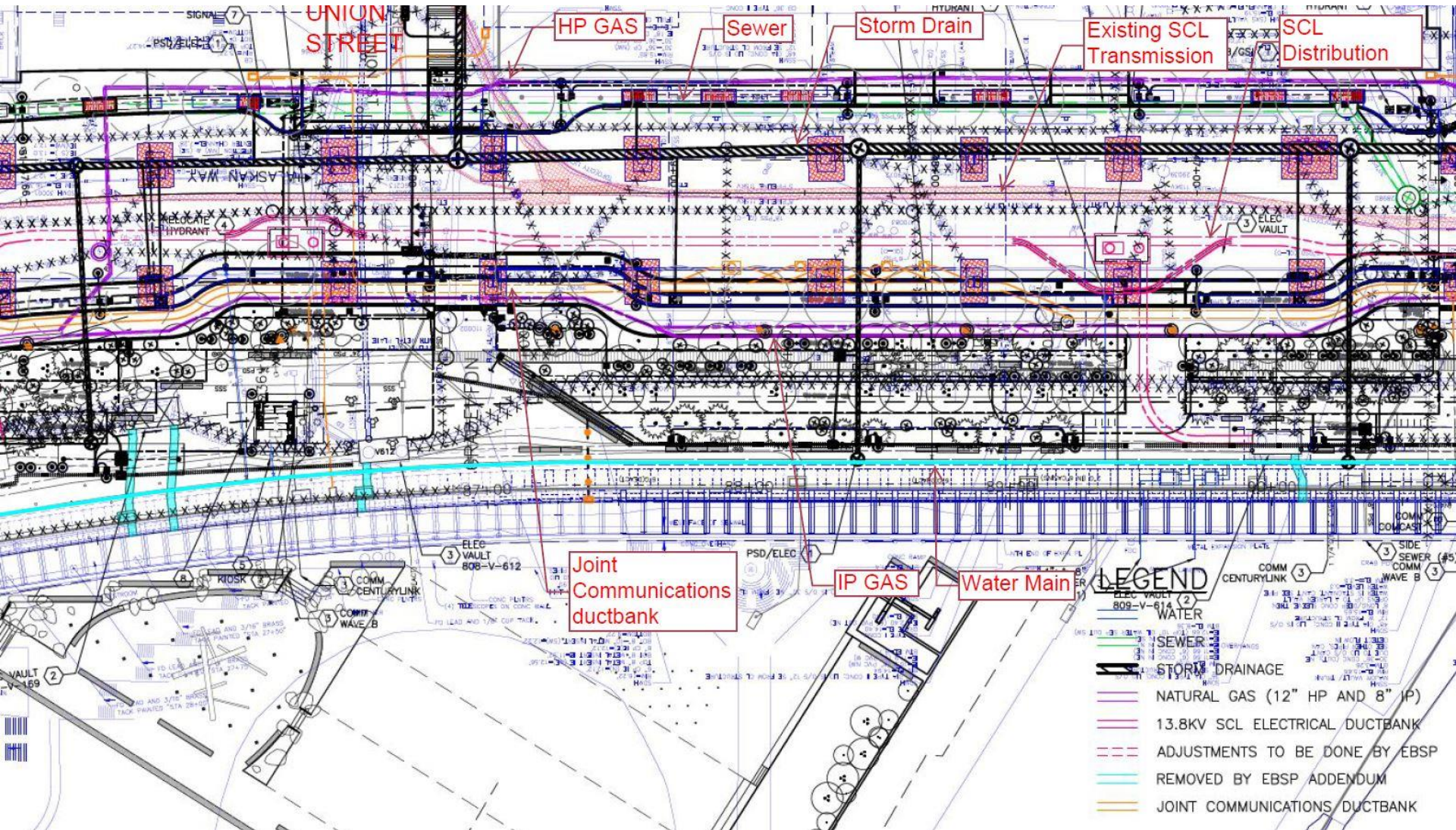

PARTNER PROJECTS – PIKE PLACE MARKET'S “MARKETFRONT”



PARTNER PROJECTS – SEATTLE AQUARIUM EXPANSION

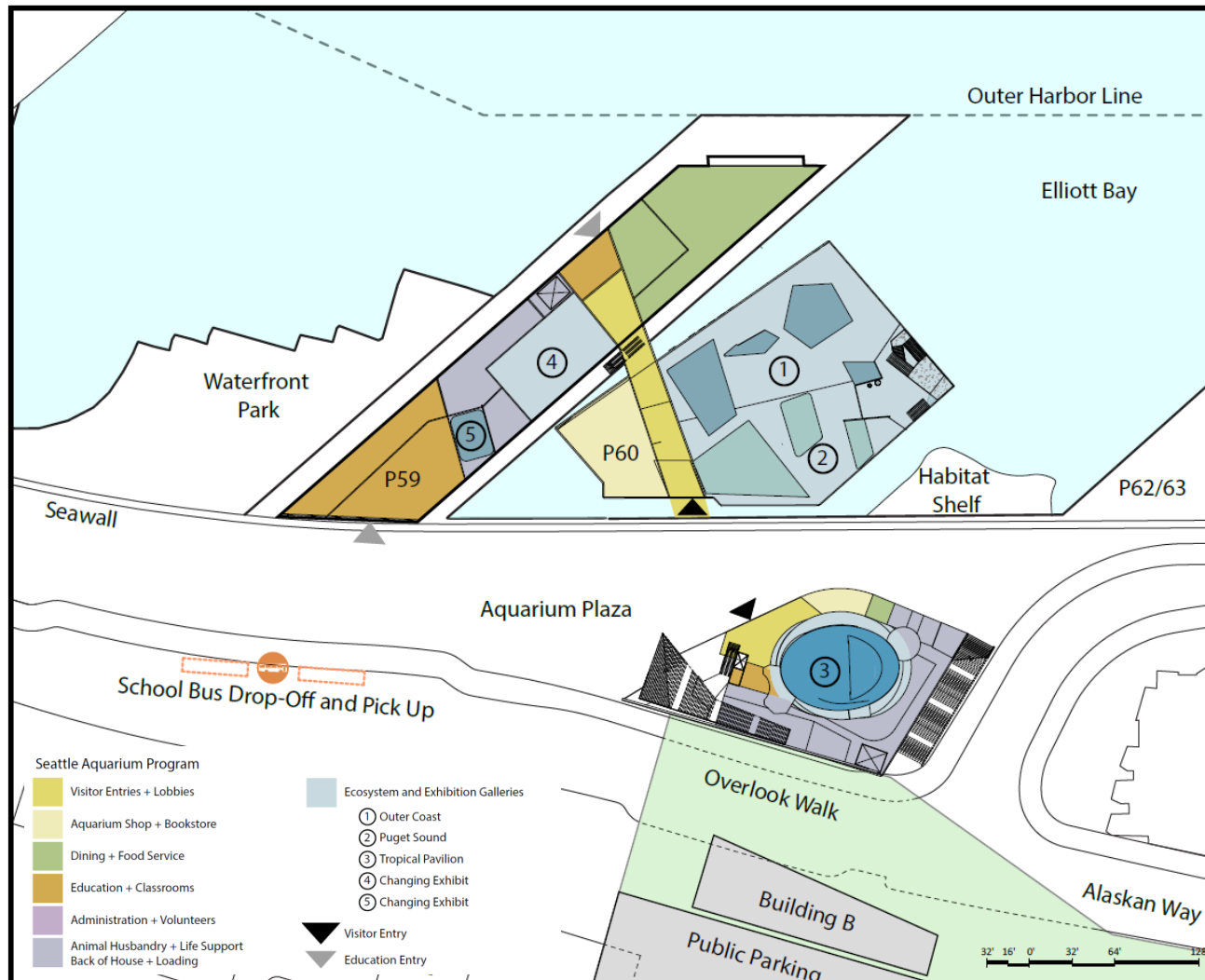

CITY/STATE FUNDING AGREEMENT CONTEXT



- “Moving Forward” Agreement in 2009; State-City MOAs in 2009 and 2011
- State agreed to fund the SR 99 tunnel, new Alaskan Way surface street, demolition of Viaduct and decommissioning of Battery Street Tunnel (cost estimated at \$290M exclusive of SR 99 tunnel)
- City agreed to fund the Seawall Project, public utility relocations, the promenade, Mercer, Spokane Viaduct and First Avenue streetcar
- State funding to be used for transportation improvements including streets, bicycle facilities, sidewalks (including standard elements such as street trees)
- State and City agreed to build a multimodal street to City standards that facilitates public access to and enjoyment of the waterfront

WSDOT FUNDING RESPONSIBILITY

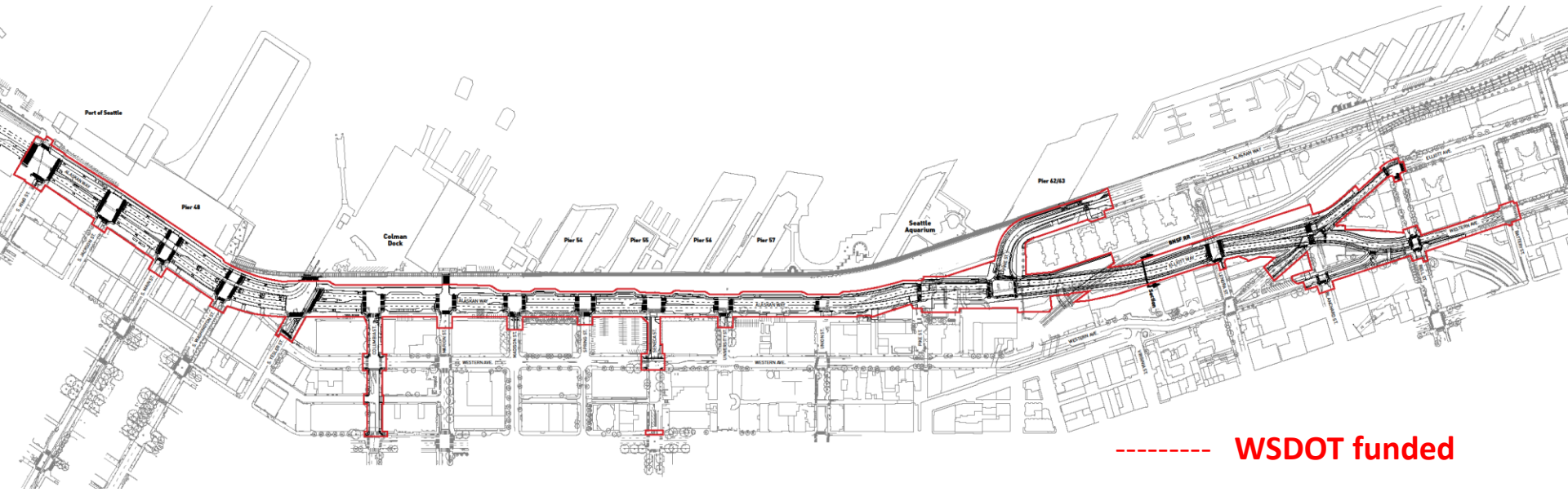

----- WSDOT funded

- Basic transportation elements (roadway)
- Crosswalks and signals
- Basic bridge structures

City funds parks (promenade, piers) and enhancements (better paving, landscaping)

UPDATED CITY/STATE FUNDING AGREEMENT SCHEDULE



FALL 2015	Practical Design Report
JANUARY 2016	Begin drafting key elements of agreement
JUNE 2016	Complete 60% design
JULY 2016	Updated cost estimate
OCTOBER 2016	CEVP Workshop Complete funding agreement for design
YE 2016	Complete funding agreement for construction



QUESTIONS?

VISIT WATERFRONTSEATTLE.ORG TO READ THE [2016 WORK PLAN](#) OR CONTACT US WITH QUESTIONS!