



PARKS, SEATTLE CENTER, LIBRARIES, AND  
WATERFRONT COMMITTEE

May 5, 2016

# TODAY'S AGENDA



- Overview of environmental review milestones
- Environmental Review Project Area
- Supplemental Draft Environmental Impact Statement (EIS) overview
- Public comment opportunities

# ENVIRONMENTAL REVIEW MILESTONES



- **Scoping period:** September 2013
- **Draft EIS released:** June 2015
- **Supplemental Draft EIS released:** April 2016
- **Final EIS – anticipated release:** Late 2016

# ALASKAN WAY, PROMENADE, AND OVERLOOK WALK



- **Main Corridor:** Improve travel between downtown and Belltown
- **Overlook Walk:** Grade-separated pedestrian crossing, views and open space
- **Promenade:** Provide public open space, pedestrian accommodations and waterfront connections
- **East-West Connections:** Improve key east-west streets to provide better pedestrian connections between waterfront and downtown

# MAP OF AWPOW PROJECTS

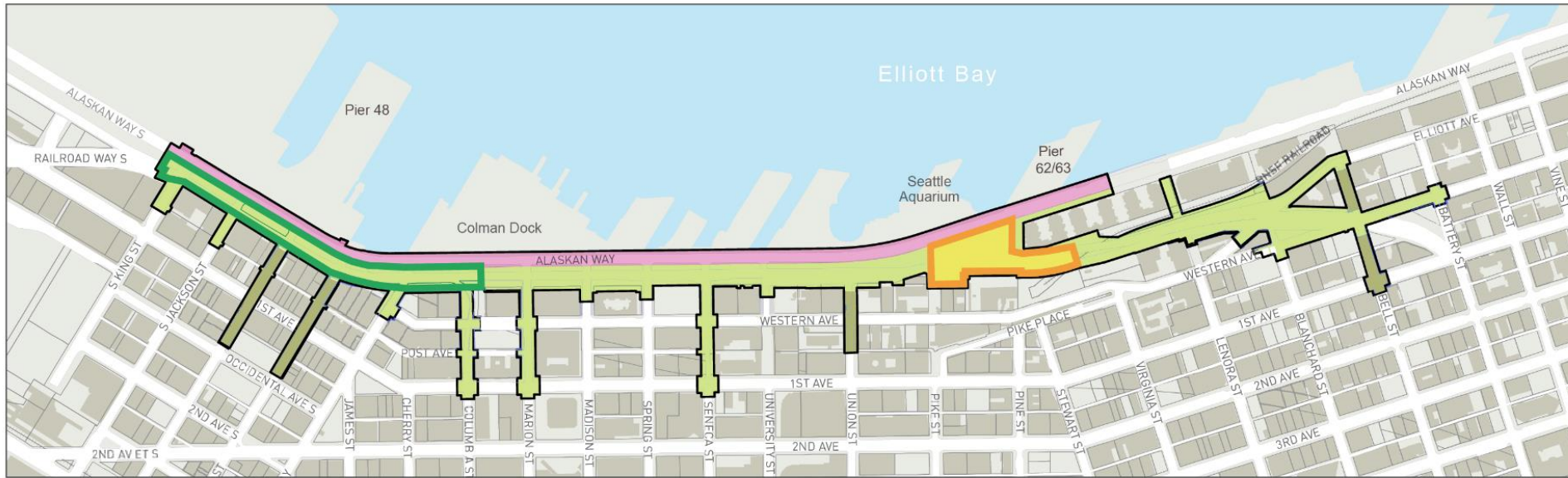

Source: SDOT

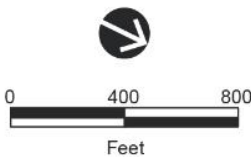

Project Footprint

AWPOW Projects

- Main Corridor
- Promenade
- Overlook Walk
- East-West Connections

- Location of Main Corridor Alternative 2 Improvements
- Location of Overlook Walk Alternative 2 Improvements

# WHY A SUPPLEMENTAL DRAFT EIS?



- Reasons for releasing Supplemental Draft EIS:
  - In response to public comments on Draft EIS
  - Evolution of design and partner projects
- Two new alternatives evaluated in Supplemental Draft EIS:
  - **Main Corridor:** A narrower Alaskan Way between S. King and Columbia streets
  - **Overlook Walk:** A revised Overlook Walk to accommodate a potential Aquarium expansion

# MAIN CORRIDOR AREA

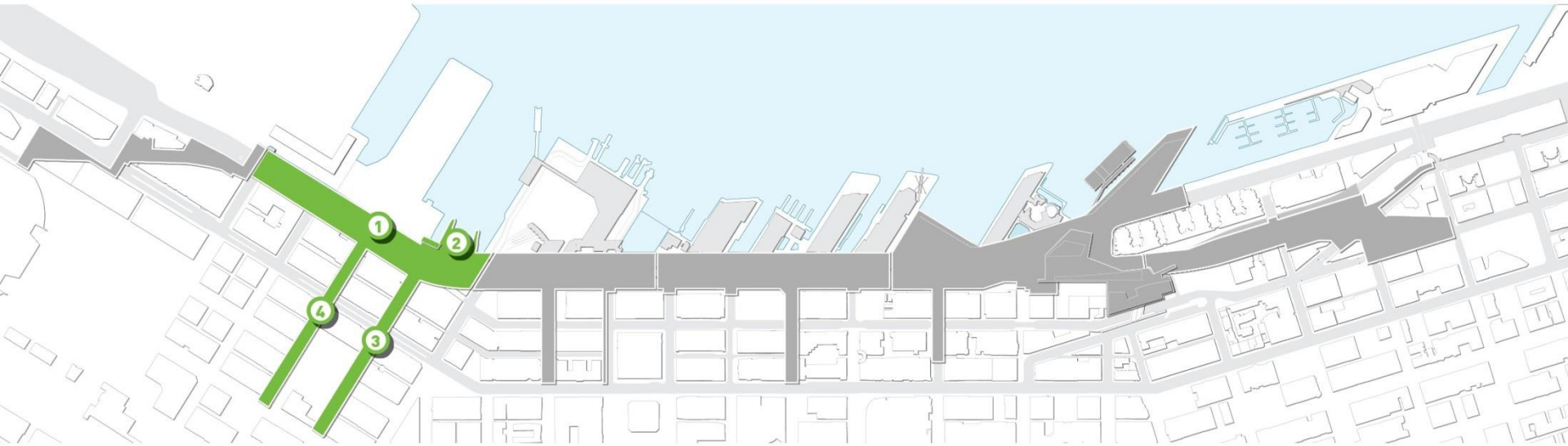

## PIONEER SQUARE

- ① MAIN CORRIDOR
- ② HABITAT BEACH
- ③ S. WASHINGTON ST.
- ④ S. MAIN ST.

# MAIN CORRIDOR AREA

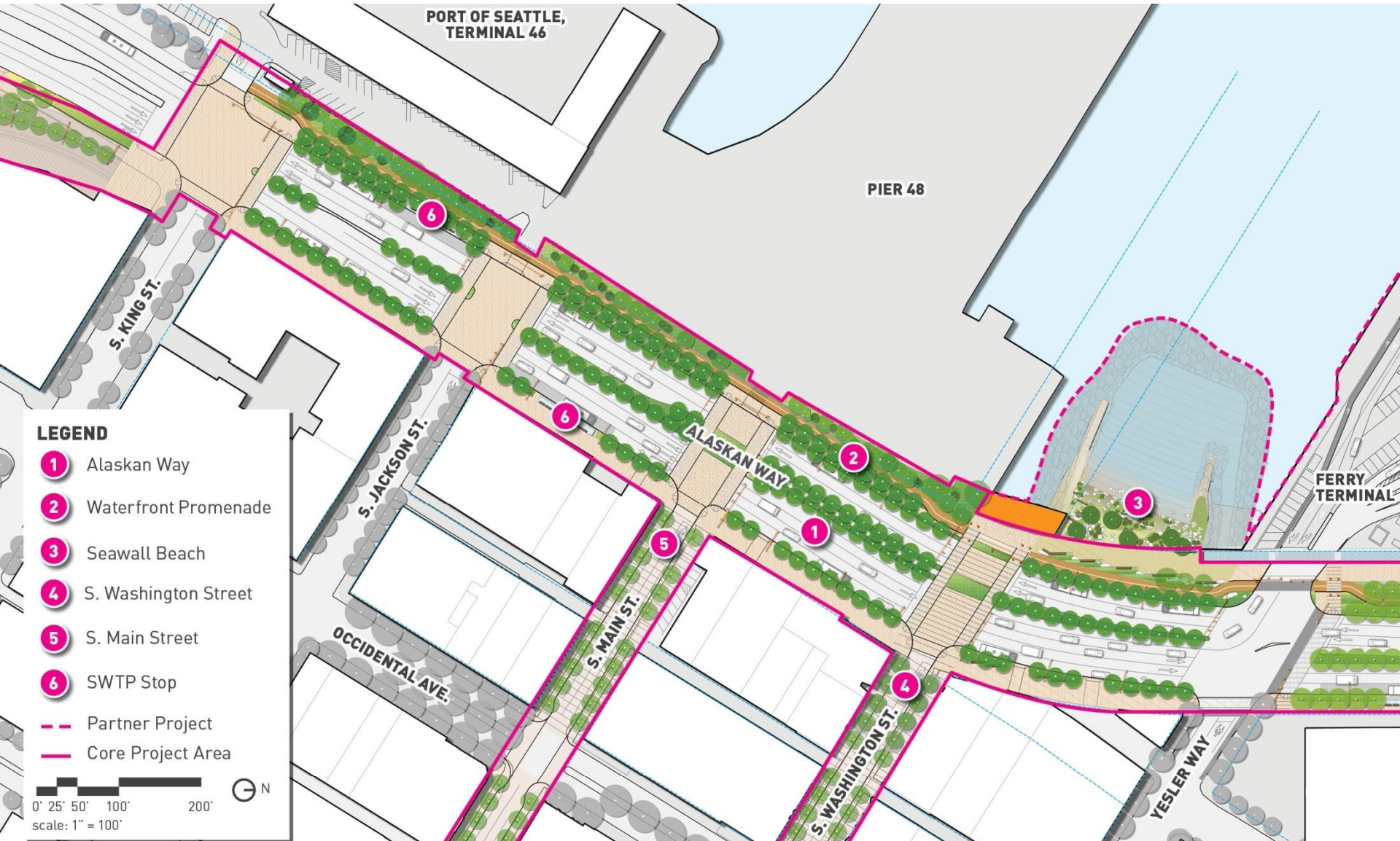



# MAIN CORRIDOR ALTERNATIVE 1



MAIN CORRIDOR ALTERNATIVE 1

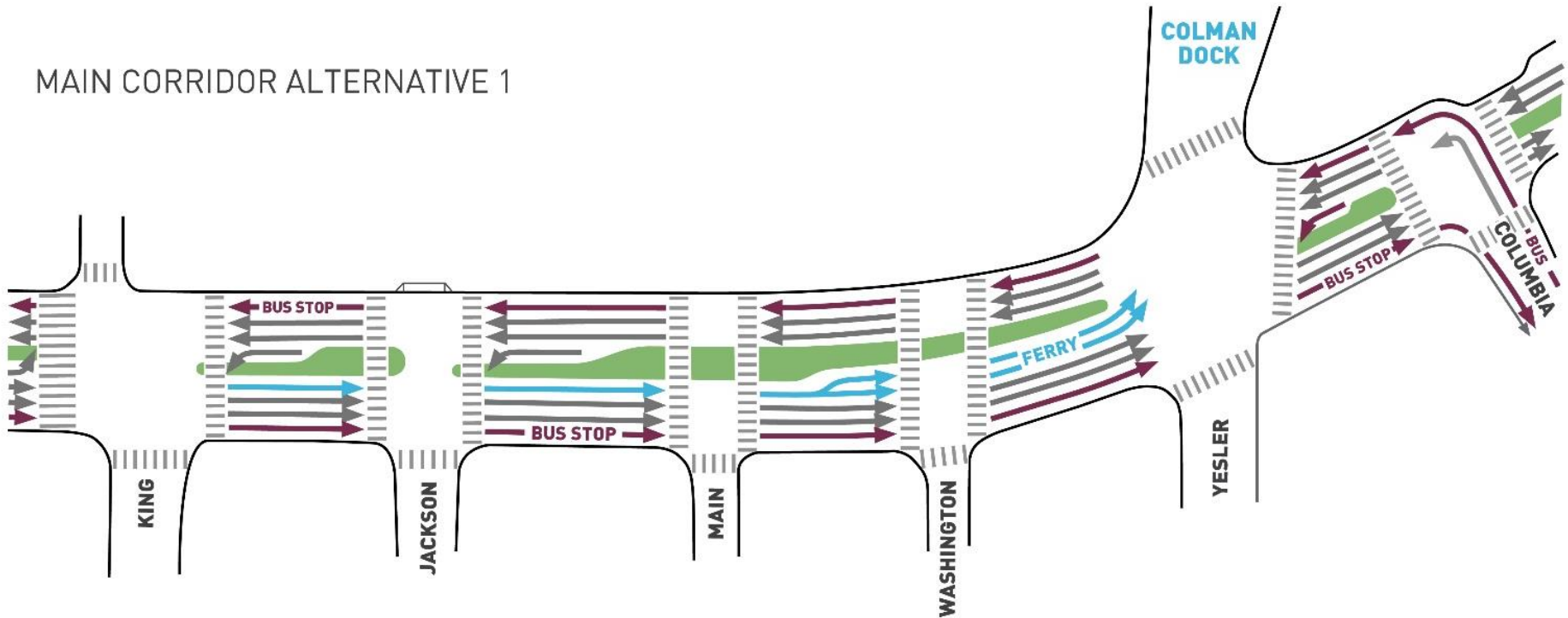

**LEGEND:**

- FERRY-ONLY
- GENERAL PURPOSE
- TRANSIT-ONLY + RIGHT TURNS
- TRANSIT QUEUE JUMP
- PARKING/LOADING

**NOTE:** EAST-WEST LANE CONFIGURATIONS UNCHANGED

# MAIN CORRIDOR ALTERNATIVE 2



MAIN CORRIDOR ALTERNATIVE 2

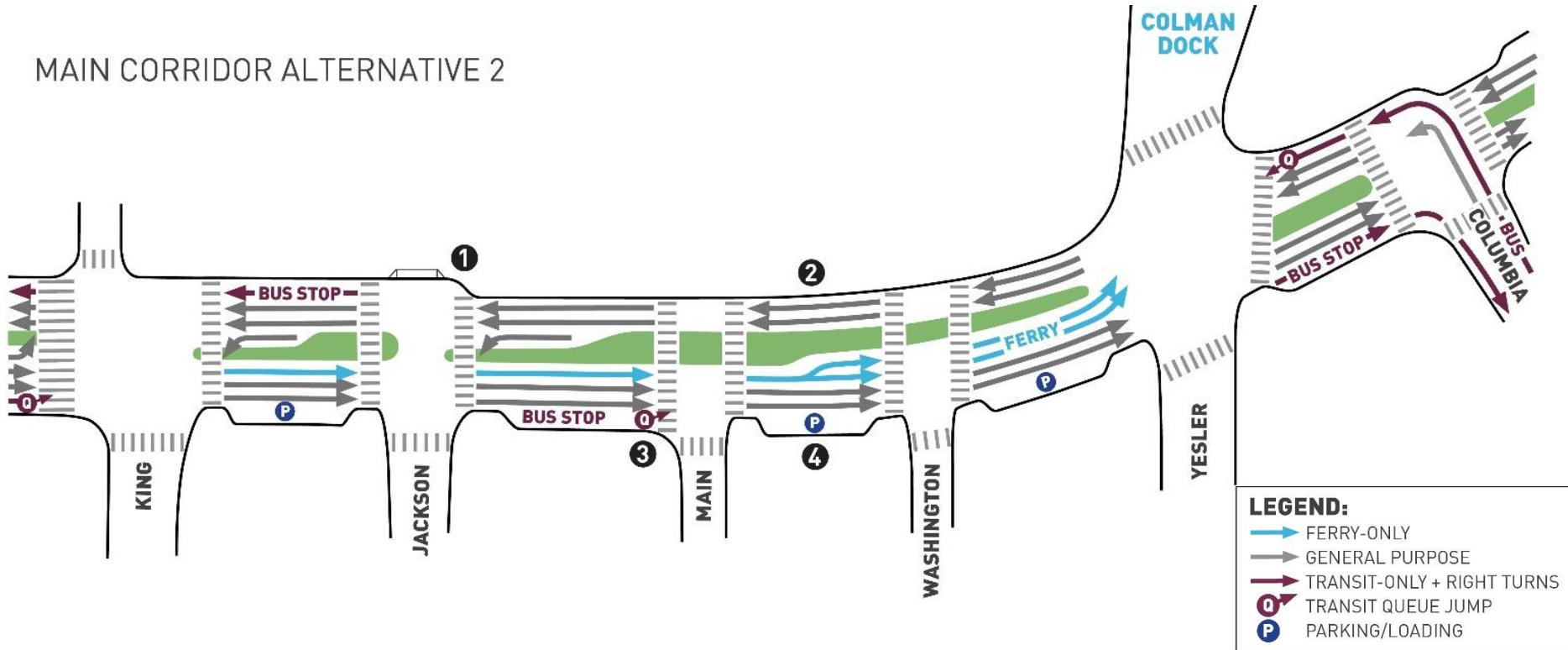

**LEGEND:**

- FERRY-ONLY
- GENERAL PURPOSE
- TRANSIT-ONLY + RIGHT TURNS
- Ⓚ TRANSIT QUEUE JUMP
- Ⓟ PARKING/LOADING

**NOTE:** EAST-WEST LANE CONFIGURATIONS UNCHANGED

## How is Main Corridor Alternative 2 different from Main Corridor Alternative 1?

- ❶ Shorter pedestrian crossing distance
- ❷ Dedicated transit lanes removed between S. King and Columbia streets
- ❸ Transit queue jumps added at Yesler Way (southbound) and S. Main and S. King streets (northbound)
- ❹ On-street parking and loading provided between S. King Street and Yesler Way

# MAIN CORRIDOR ALTERNATIVE 2

## KEY IMPACTS



### TRANSPORTATION

- Would increase congestion and travel times for both general-purpose traffic and transit traffic
- Increased congestion on nearby streets
- Reduced roadway width would shorten pedestrian crossing times

### PARKING

- Would provide additional on-street parking/loading spaces between S. King Street and Yesler Way compared to Alternative 1

# ROADWAY FEATURES



# OVERLOOK WALK

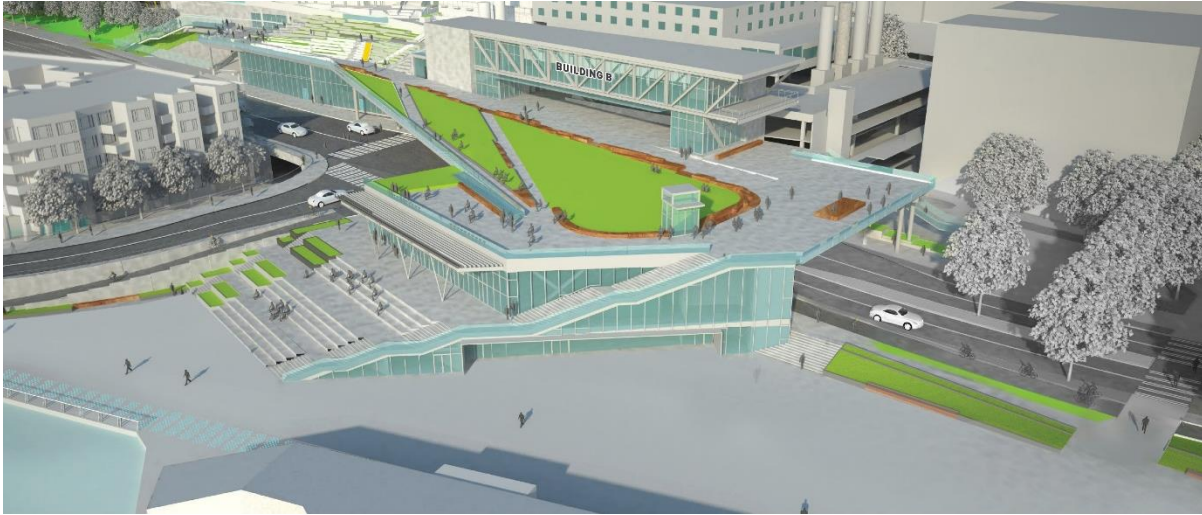

**OVERLOOK WALK  
ALTERNATIVE 1  
(WITH BUILDING C)**



**OVERLOOK WALK  
ALTERNATIVE 2  
(WITH AQUARIUM  
PAVILION)**

# OVERLOOK WALK ALTERNATIVE 2

## KEY IMPACTS



### CONSTRUCTION

- If the Overlook Walk were completed prior to the Aquarium Pavilion, the construction period would be longer than if the two projects were built concurrently

### AESTHETICS

- Aquarium Pavilion would be larger, which could obstruct views
- Staircases would have less expansive view opportunities toward Puget Sound
- Public open space and viewing deck would be expanded onto Aquarium Pavilion roof, providing improved view opportunities

# PUBLIC OUTREACH



- Goal: Broad notification of Supplemental Draft EIS release to encourage public review and comments
- Notification tools:
  - Legal Notice published in DJC and Seattle Times
  - SDEIS available for review at [waterfrontseattle.org](http://waterfrontseattle.org) and at libraries throughout Seattle
  - Additional notifications in print and online media (e.g., La Raza del Noroeste, Seattle Chinese Times)
  - Press release and social media posts
  - Email to project list (7,000+ email addresses) and all DEIS commenters
  - Mail postcard to properties within 200 feet of project area
  - Public meeting: May 10, 4:30 – 7:30 PM, Bertha Knight Landes room

# PUBLIC COMMENTS



- Multiple ways to submit comments:
  - Comment online at [waterfrontseattle.org](http://waterfrontseattle.org)
  - Email comments to [sdeis@waterfrontseattle.org](mailto:sdeis@waterfrontseattle.org)
  - Mail written comments to City
  - Via court reporter or written comment form at the public meeting: May 10, 4:30 – 7:30 PM, Bertha Knight Landes room





**QUESTIONS?**