

# Seattle Parks and Recreation Capital Projects Update

Community Center Major Maintenance Projects  
and Community Center Site Projects

Civic Development, Public Assets and Native Communities Committee

June 20, 2018

Seattle Parks and  
Recreation



City of Seattle



# Community Center Capital Project Update

## Major Maintenance Work

- CC Stabilization Projects
- CC Improvement Projects
- Additional CC Site and Play Area work



# 9 Sites Identified for Major Maintenance

Prioritized in the 2016 Community Center Strategic Plan based on 2008 condition assessments

- Hiawatha CC
- Jefferson CC
- Loyal Heights CC
- Magnolia CC
- South Park CC
- Queen Anne CC
- Magnuson CC
- Green Lake CC
- Lake City CC

Funds from Park District: \$3.5 million per year

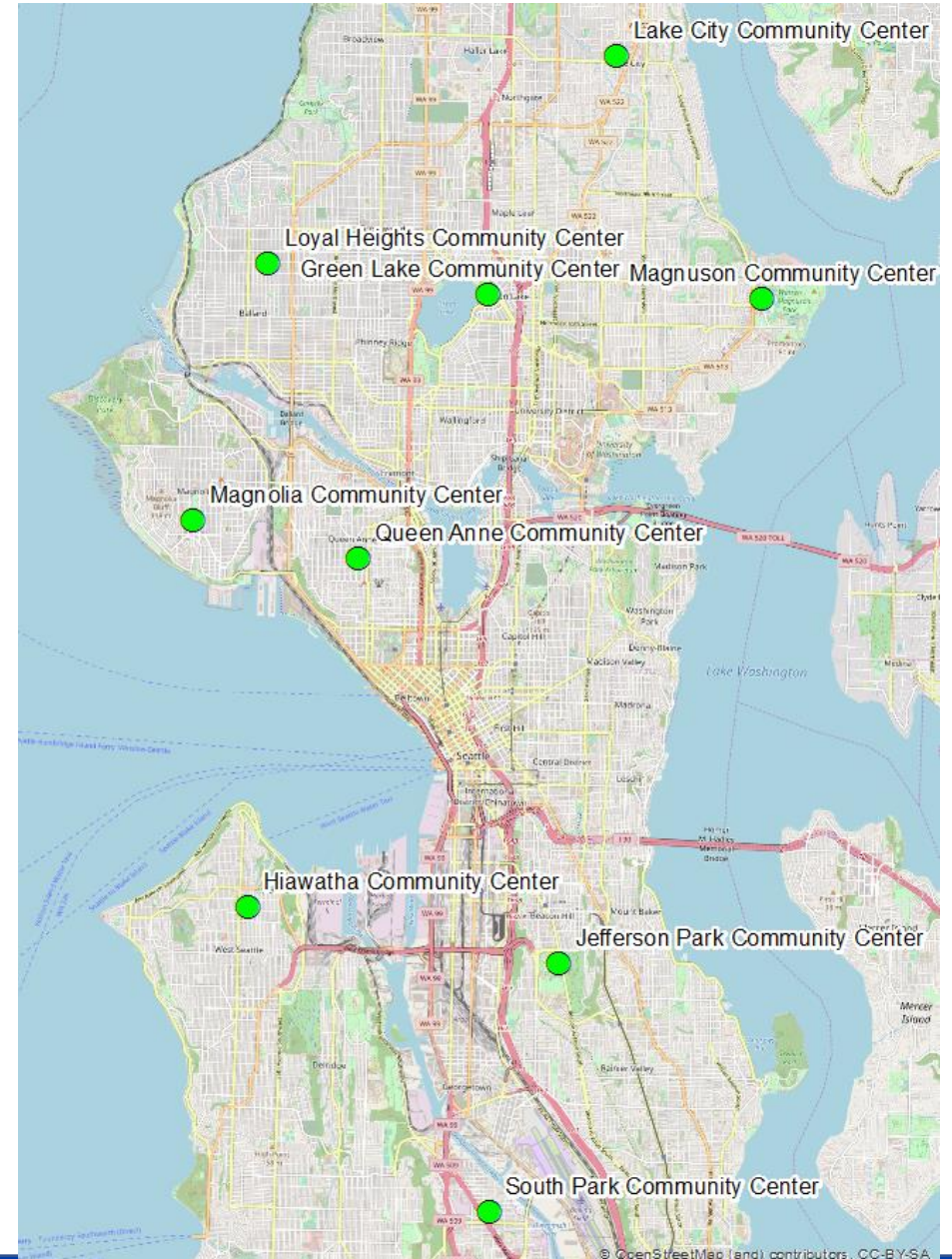



# Stabilization Projects

Major maintenance projects focused on extending the life of the facilities and increasing programming potential



Preservation

- Re-roofing
- Window replacement

Safety

- Seismic upgrades
- Hazardous material abatement

Access

- Pathways from parking to entrance
- Accessible programming space

# Stabilization Projects

Site	Budget	Funding Source (s)
Hiawatha CC	\$1.8 million	2008 Levy and Seattle Park District (2018)
Jefferson CC	\$1.7 million	Park District (2018, 2019)
Loyal Heights CC	\$3.8 million	REET and Park District (2017, 2018)
Magnolia CC	\$2.8 million	Park District (2018, 2019)
Queen Anne CC	\$1.7 million	Park District (2016, 2017, 2018)
South Park CC	\$1.4 million	Park District (2017, 2018)
Green Lake CC	\$2.9 million	2008 Levy and REET

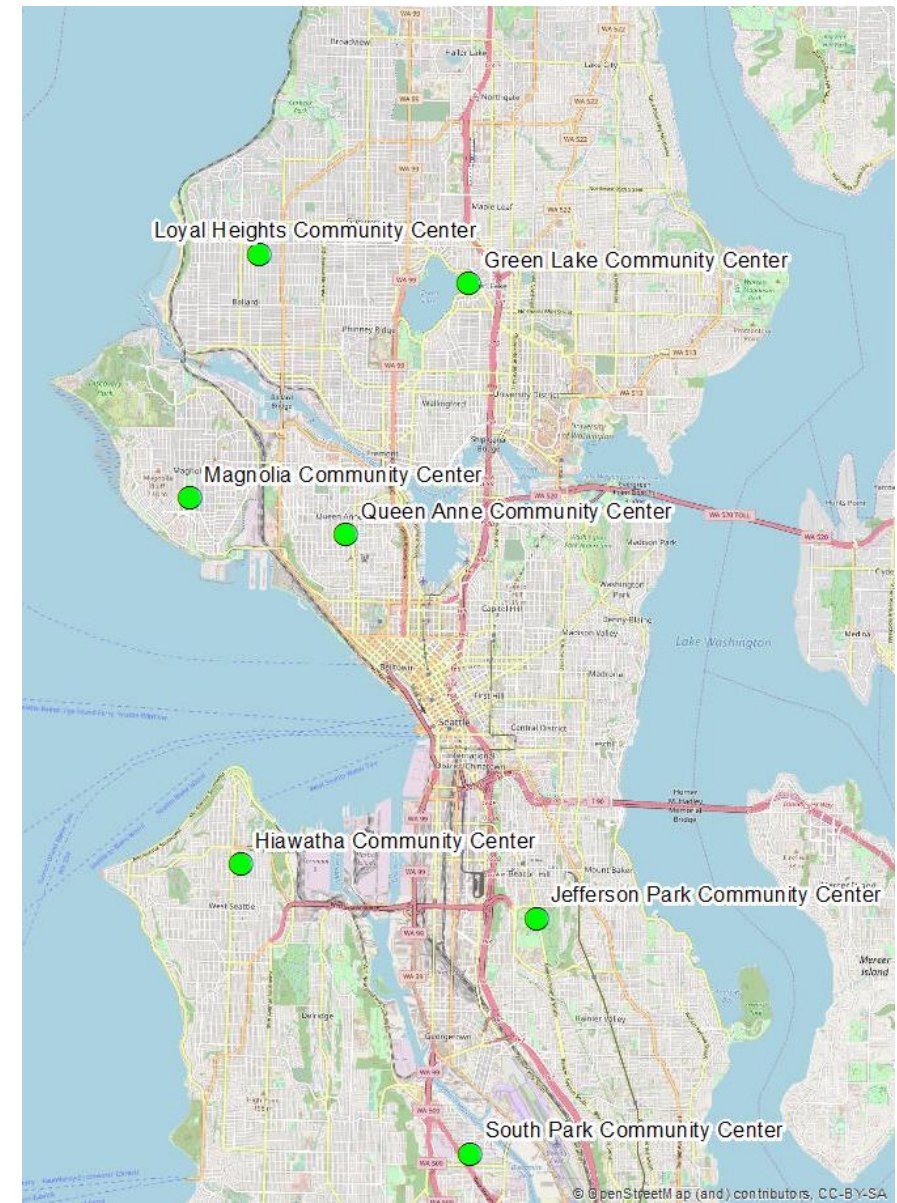



# Stabilization Projects: CC Schedule

Projects will be designed and bid in two groups with the same schedule

- **Current:** Testing and pre-engineering
- **2018 Q3 – 2019 Q3:** Design and Permitting
- **2019 Q3:** Bidding target
- **2020 Q1 – 2021 Q2:** Construction



# Stabilization Project Example: South Park CC

Trellis repainting

Entry and gym re-roof

Front desk and lobby remodel

Kitchen update

Exterior restroom remodel

Exterior panel replacement

Office ventilation improvements

Interior restroom remodel



# Stabilization Project Example: In-House Work





# Stabilization Project Example: Green Lake CC / Evans Pool





# Improvement Project: Magnuson CC (Bldg. 47)



**Budget:** \$2.15 million  
**Funding sources:** King County (\$1 million), Real Estate Excise Tax -- REET (\$1.15 million)  
**Estimated Completion:** Q3 2021

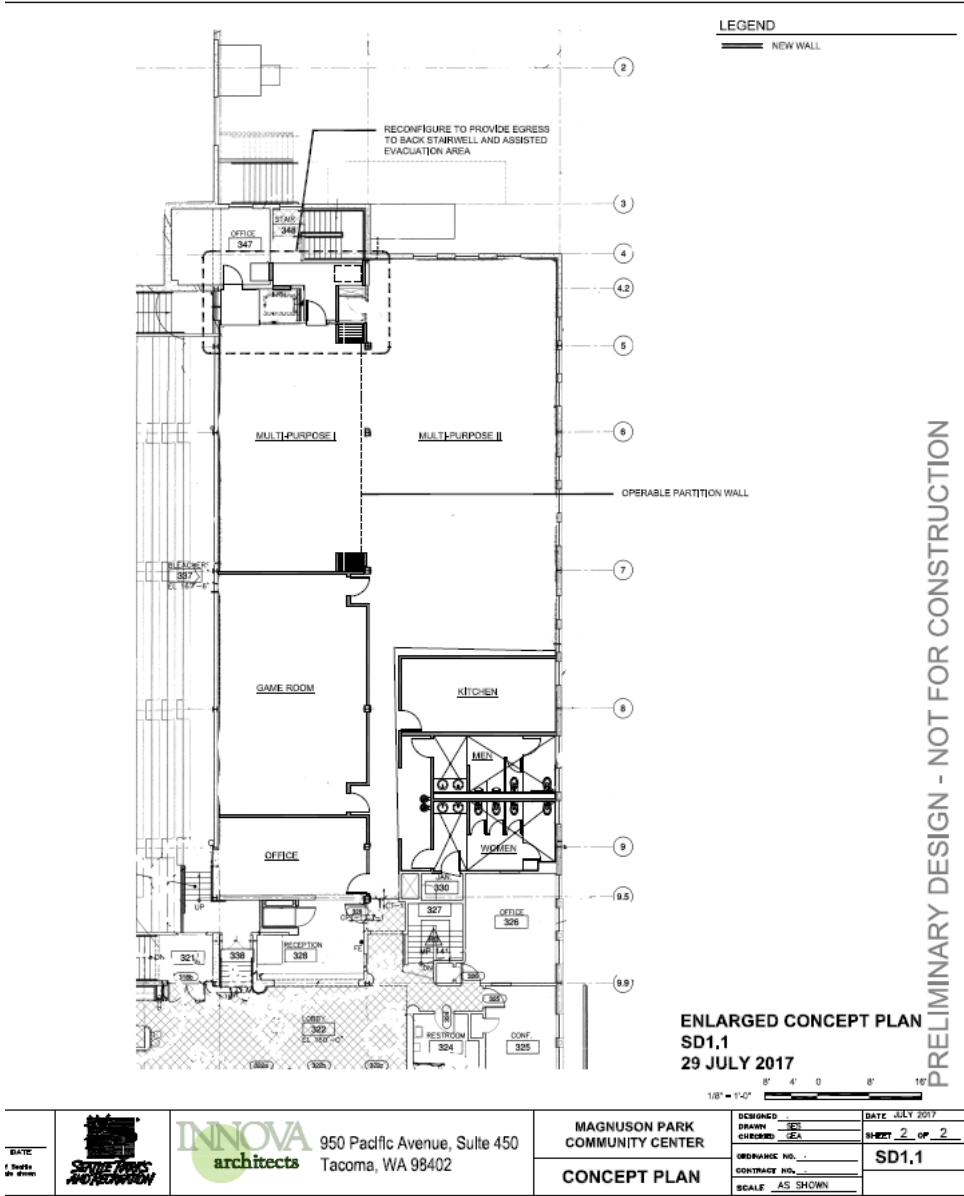



# Site Work Example: South Park CC Campus Planning



**Estimated Budget:** \$9.8 million

**Committed Funds:** \$800,000 for play area (Park District)

**Estimated Completion:** Dependent on fund-raising





# Site Work Example: Hiawatha Play Area Renovation

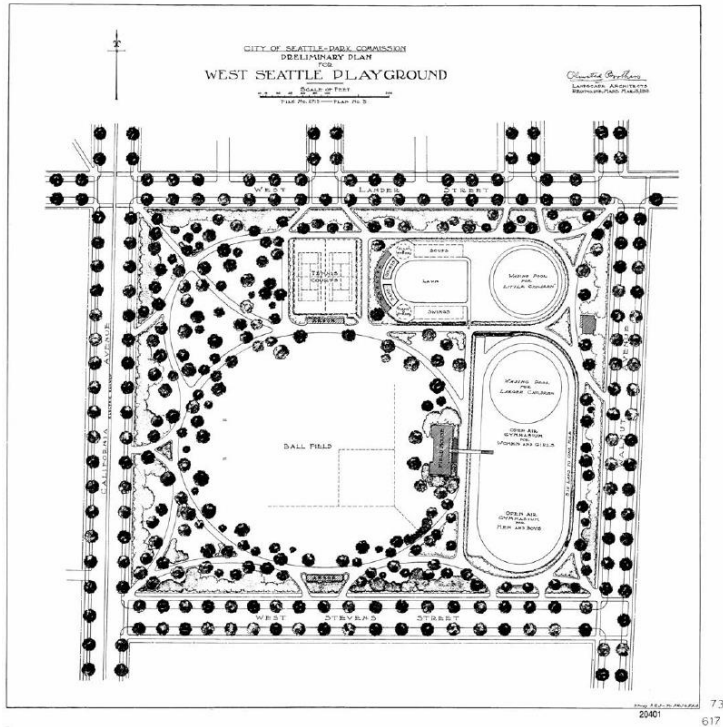

**Budget:** \$800,000

**Funding Source:** King County

**Estimated Completion:** Q1-Q2 2020





# Site Work Example: Loyal Heights Playfield Improvements

- **Play Area Renovation**

Budget: \$600,000 (Funding Source: King County)

Estimated Completion: Q4 2018

- **Synthetic Turf Replacement**

Budget: \$2.4 million (Funding Source: REET)

Estimated Completion: Q3 2019



