

# Race & Social Justice

## Report to Housing, Health, Energy & Worker's Rights Committee



**Seattle**  
Office of Housing

### City-Funded Affordable Housing

- 2018 Rental Investments (New)
- 2018 Rental Reinvestments (Rehabilitation)
- Previously Funded Rental Housing Portfolio
- 2018 Homeownership Investments

*Source: Office of Housing (2019)*

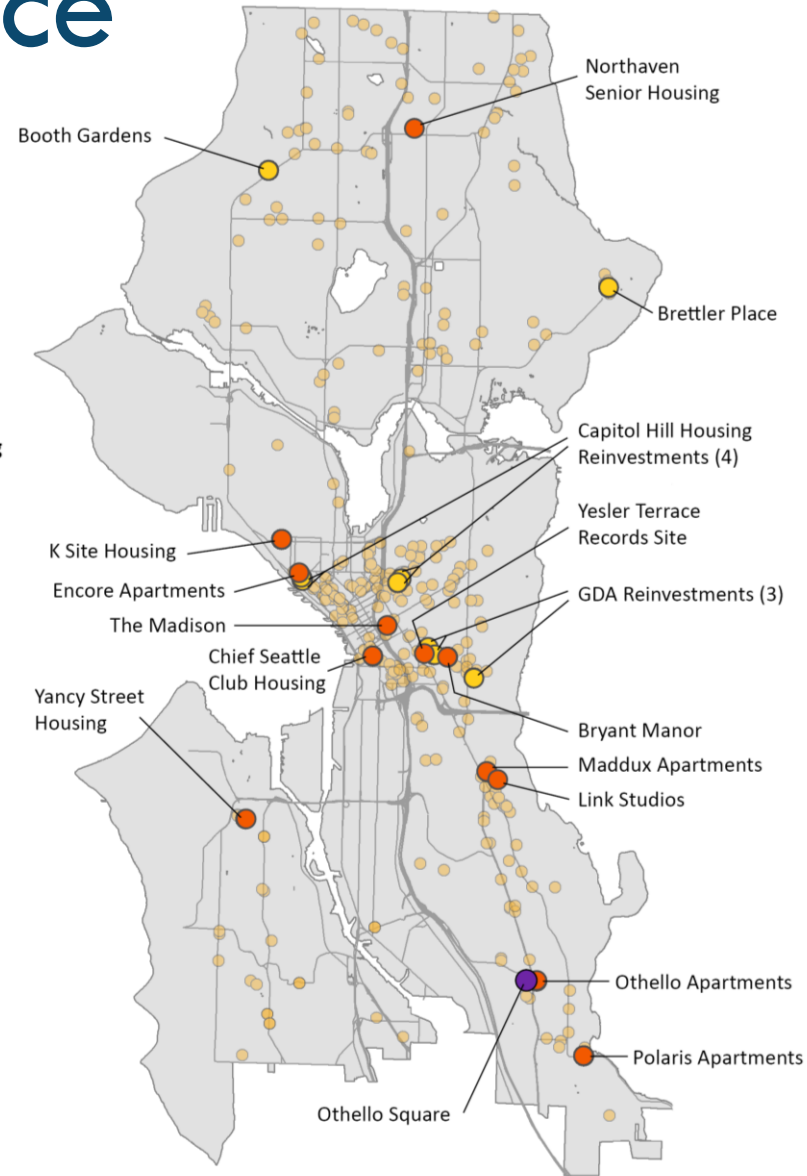

September 19, 2019

# Housing Affordability: A Racial Equity Issue

## Severe Housing Cost Burden by Race/Ethnicity

Over 25% of Black/African American owners, and close to 35% of Black/African American renters, pay more than half of their incomes for housing.

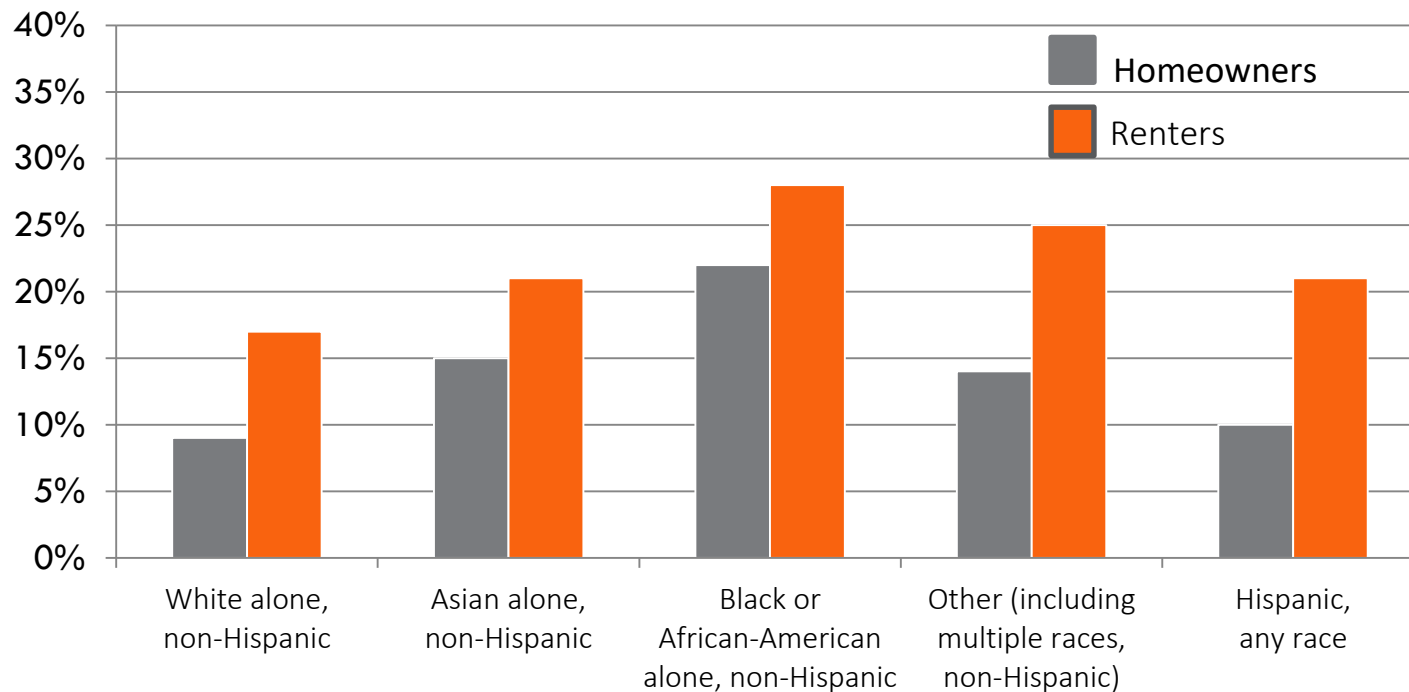

# Race Demographics of OH Funded Housing

**Race/Ethnicity of Residents**  
OH-Funded Affordable Housing

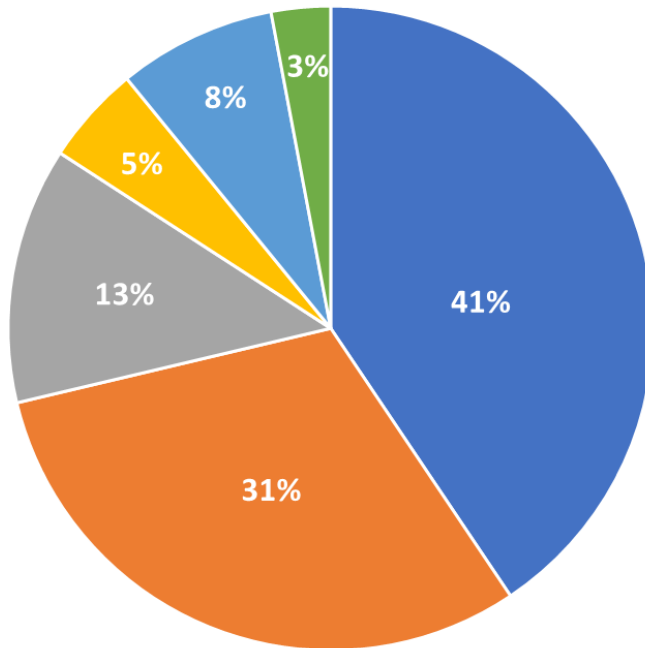

- White
- Asian/Pacific Islander
- Multi-racial

**Race/Ethnicity of Residents**  
Seattle

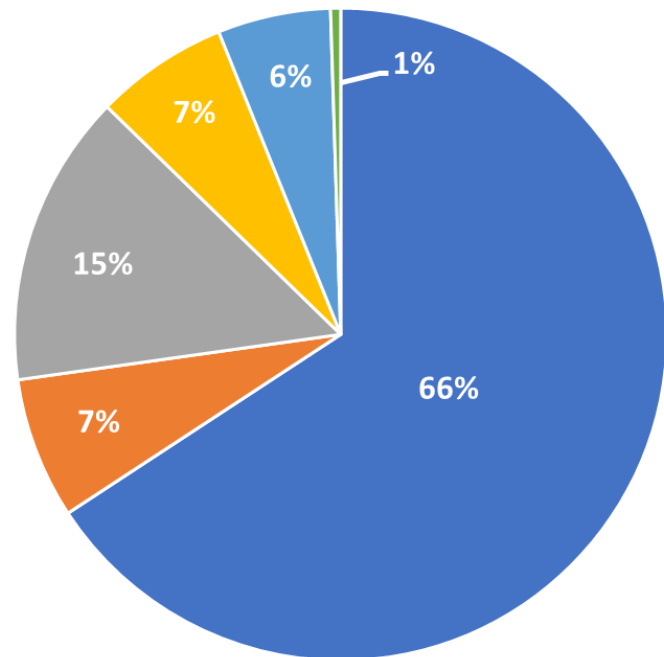

- Black/African American
- Hispanic or Latino (of any race)
- American Indian/Alaska Native

# Support for Women and Minority Owned Business (WMBE)



- Multi-family lending staff encourages housing developers to increase WMBE participation
- Asset Management staff incorporates message encouraging WMBE utilization in site inspection reports

	WMBE Goal	Actual
Purchasing	40%	77%
Consulting	20%	18%
Weatherization	NA	45%

# Change Team Development

- OH Change Team has grown to 14 members, doubling in size to include over 30% of department staff
- CT Work: Staff trainings, staff survey, RSJI focused events, staff newsletter



# Community Preference & Affirmative Marketing

**Policy Goal:** Address historic and current displacement by providing preference for community residents during leasing or sales

## Community Preference Guideline Development

Q1: Community workshop

Q3: Stakeholder roundtable

Q4: Draft guideline to be released

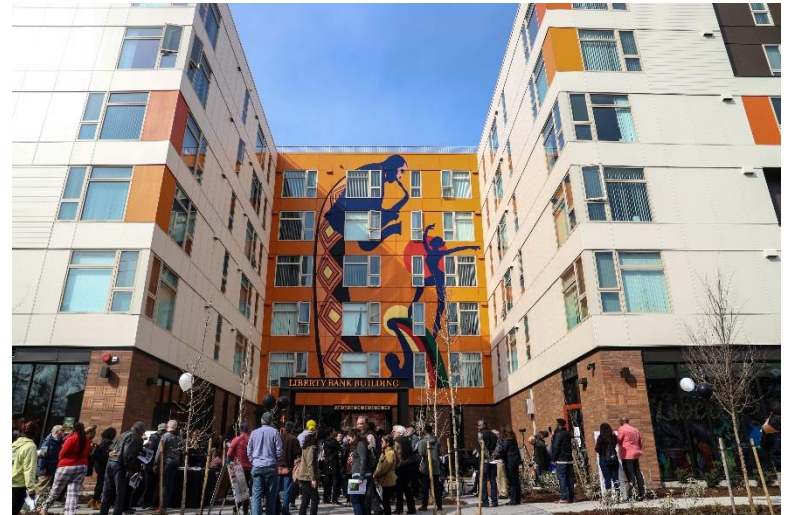

# Homeownership Stabilization Programs

- **Community Engagement & Outreach**

- § Neighborhood-based strategy
- § Community-centered partnerships

- **Increase equity & access**

- 1:1 application assistance
- Reducing application barriers

- **New program design and implementation**

- Weatherization + Health program
- Oil-to-Electric pilot program
- Livable Space pilot program





# Homeownership

- Six meetings with Southeast Seattle community organizations exploring use of surplus sites for permanently affordable homeownership
- **Yakima & Othello Square**
  - Interest in using community preference
  - Best practices to ensure there is a qualified pool of buyers
- **Community Ownership Capacity Building Grant**
  - Supporting creation of Othello Square, the city's first-ever limited-equity cooperative
  - Supporting Yakima Homebuyer Club





# 2019 Racial Equity Toolkits and Workplan

## **Toolkits:**

- Rent affordability levels in areas at risk of displacement
- Community Preference Policy
- Weatherization Application
- Sound Transit Homeownership sites

## **Other Upcoming Work:**

- Census Outreach
- ADU equitable loan pilot program development

# Questions?



**Seattle**  
Office of Housing