An aerial photograph of Seattle, Washington, showing a dense urban landscape with numerous skyscrapers and buildings. In the foreground, the waterfront area is visible, including the Smith Tower and the waterfront promenade. The city is surrounded by water, and the background shows more city buildings and hills.

Strategies to keep people and goods moving in and through Seattle

SR 99 Closure and the Seattle Squeeze 2018-2024

City of Seattle Full Council
December 10, 2018



City of Seattle

How we get around is about to change

Over the next five years private and public construction projects will continue to change how we move and deliver goods



Where we are headed



Pike Pine Renaissance



Central Waterfront



WA State Convention Center



Key Arena



Growing light rail system

Our five pillars for downtown mobility



Monitoring and managing
our transportation system



Reducing the number of
drive-alone trips downtown



Investing in transit and
expanding access



Managing the public
right-of-way



Communicating
with the public



Program schedule

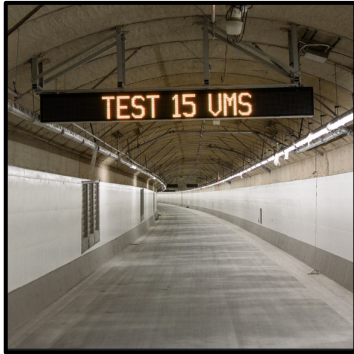

2018

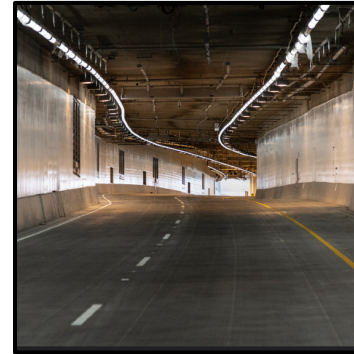
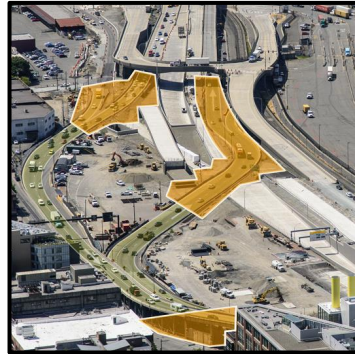

Early 2019



Tunnel preparation

Fall 2018:

- Switch Alaskan Way travel lanes west (complete)
- Complete tunnel systems testing
- Operations, maintenance and emergency responder staff training
- Preparatory tunnel on- and off-ramp work

SR 99 closure

Jan. 4:

- On- and off-ramps near stadiums close

Jan. 11:

- Full SR 99 closure begins
- Finish eight ramps to/from new tunnel
- Realign SR 99 into new tunnel
- Tunnel grand opening celebration

Tunnel opens

Feb*:

- Closure ends and SR 99 tunnel opens
- SR 99 NB off-ramp to downtown and Alaskan Way opens

Work begins

Feb*:

- Viaduct removal
- Closing and filling Battery Street Tunnel
- Rebuilding three blocks of Aurora Avenue North

*Closure is approximately three weeks long but duration will depend on progress.

Why close SR 99 for three weeks?

Connecting SR 99 to the tunnel: Crews will have to work in the path of SR 99's current configuration to connect SR 99 to the new tunnel. The graphics below show the path of SR 99 today (yellow) and work zones during the closure (orange).

Ramp closures - Up to six week of impact:

- **On Jan. 4, 2019,** WSDOT will close the S Atlantic St. southbound off-ramp and the northbound Royal Brougham Way on-ramp.
- **After the new SR 99 tunnel opens,** the northbound off-ramp to downtown will remain closed for up to two weeks.



South SR 99 tunnel portal



North SR 99 tunnel portal

SR 99 closure and tunnel opening: get ready

Scheduled to begin Jan. 11, 2019

- **Duration:** about three-weeks for SR 99 closure and up to three weeks of ramp closures
- **Closing a highway adds more drivers to other parts of the system:** 90,000 vehicles per day, including several thousand trucks, and buses have to use another route
- **Expect long backups:** On I-5 and routes into downtown Seattle, especially during peak commute times
- **Major change to transportation system:** New SR 99 tunnel will open, other construction continues

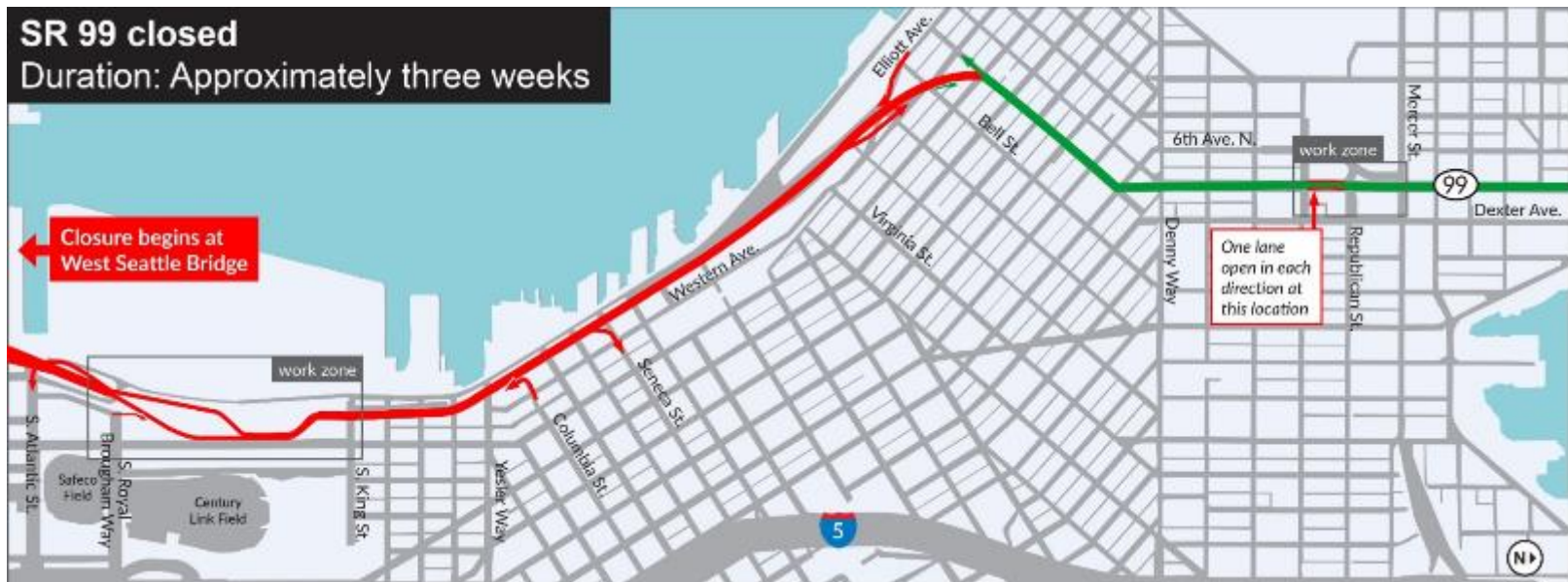



Feb. 2 – 3, 2019

Event agenda

99StepForward.com

Saturday

- Fun run
- Ribbon cutting ceremony
- Public festival
- Public tunnel walk/access
- Goodbye to the viaduct/
hello waterfront

Sunday

- Bike ride

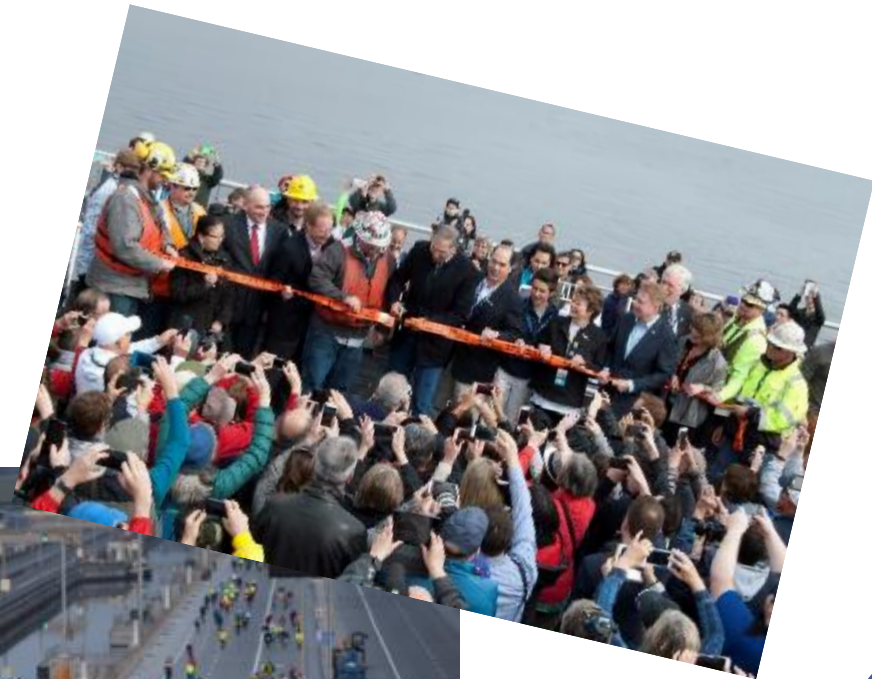

Finding a new normal in ongoing changes

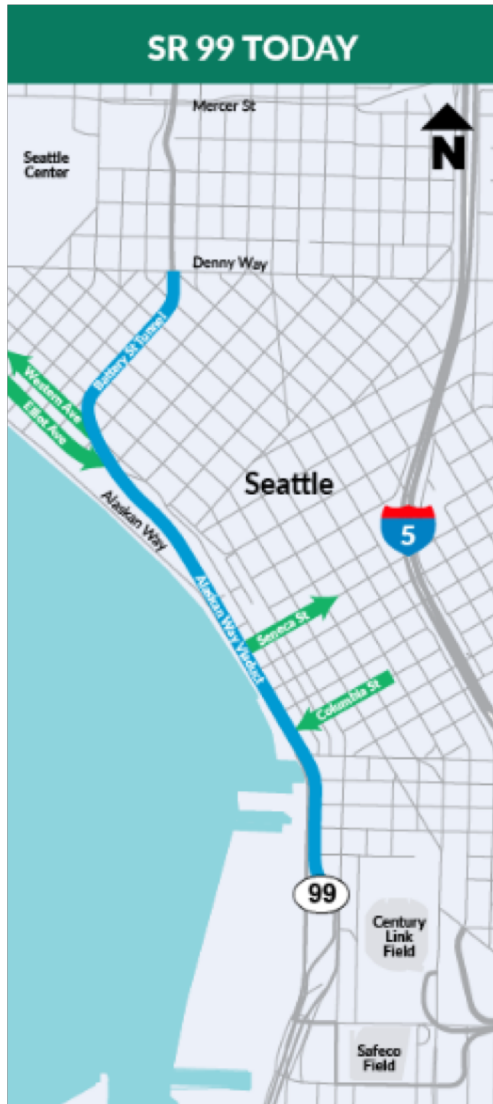

Opening the new SR 99 tunnel is just the start:

- Tunnel will open toll-free for a period of time.
- Traffic patterns will change because we are changing access to SR 99.
- Construction continues after the tunnel opens to drivers.

Seattle will experience ongoing change:

- It will take time before traffic patterns settle out.
- Tolls range from \$1 to \$2.25 with a *Good To Go* pass.
- Some trips will be quicker and others will be longer.
- The City will rebuild the new Alaskan Way, which will open in 2021.

New SR 99 ramps at the north portal – Looking north

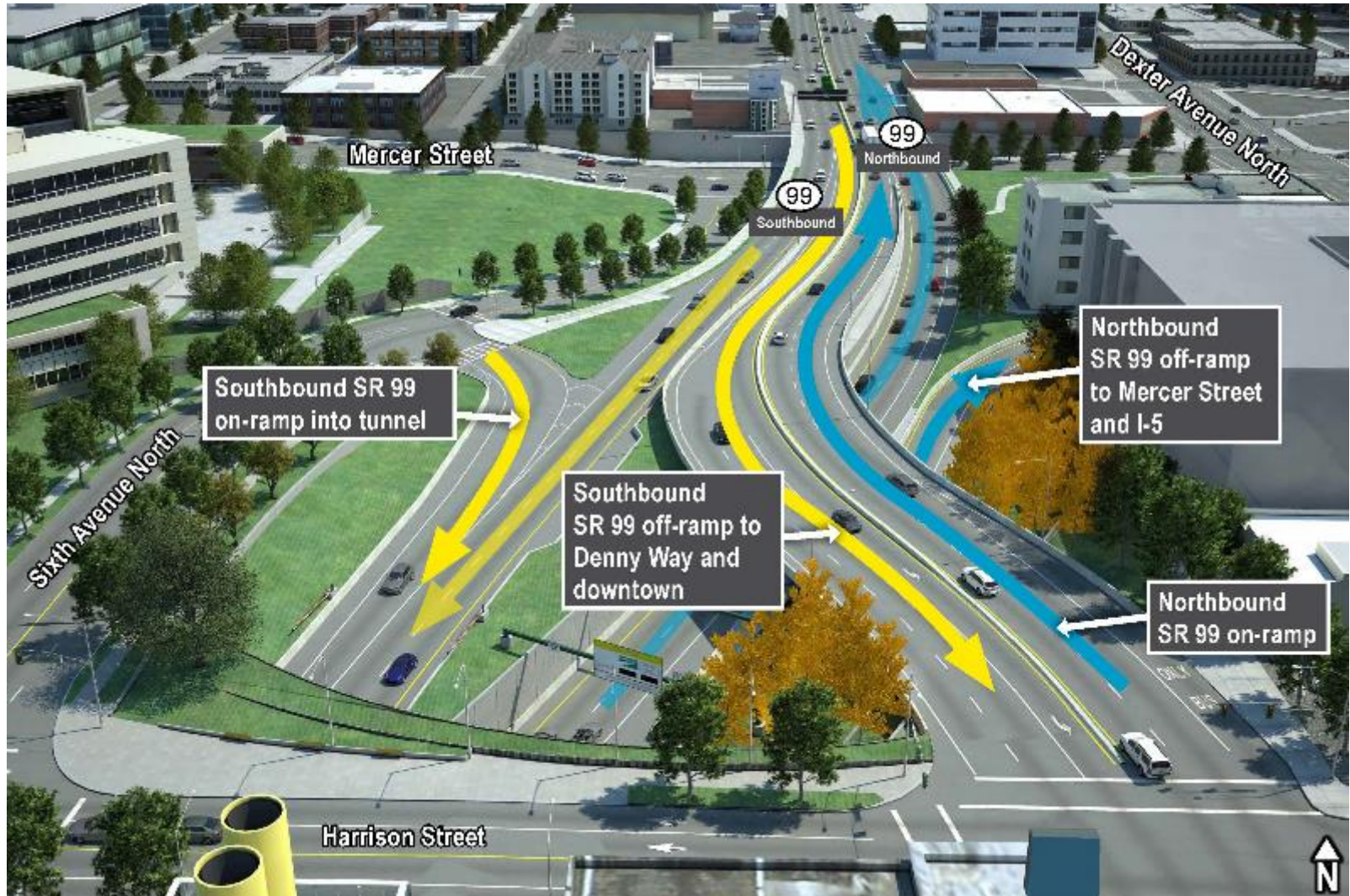

Opening the tunnel: Ramps at the south portal

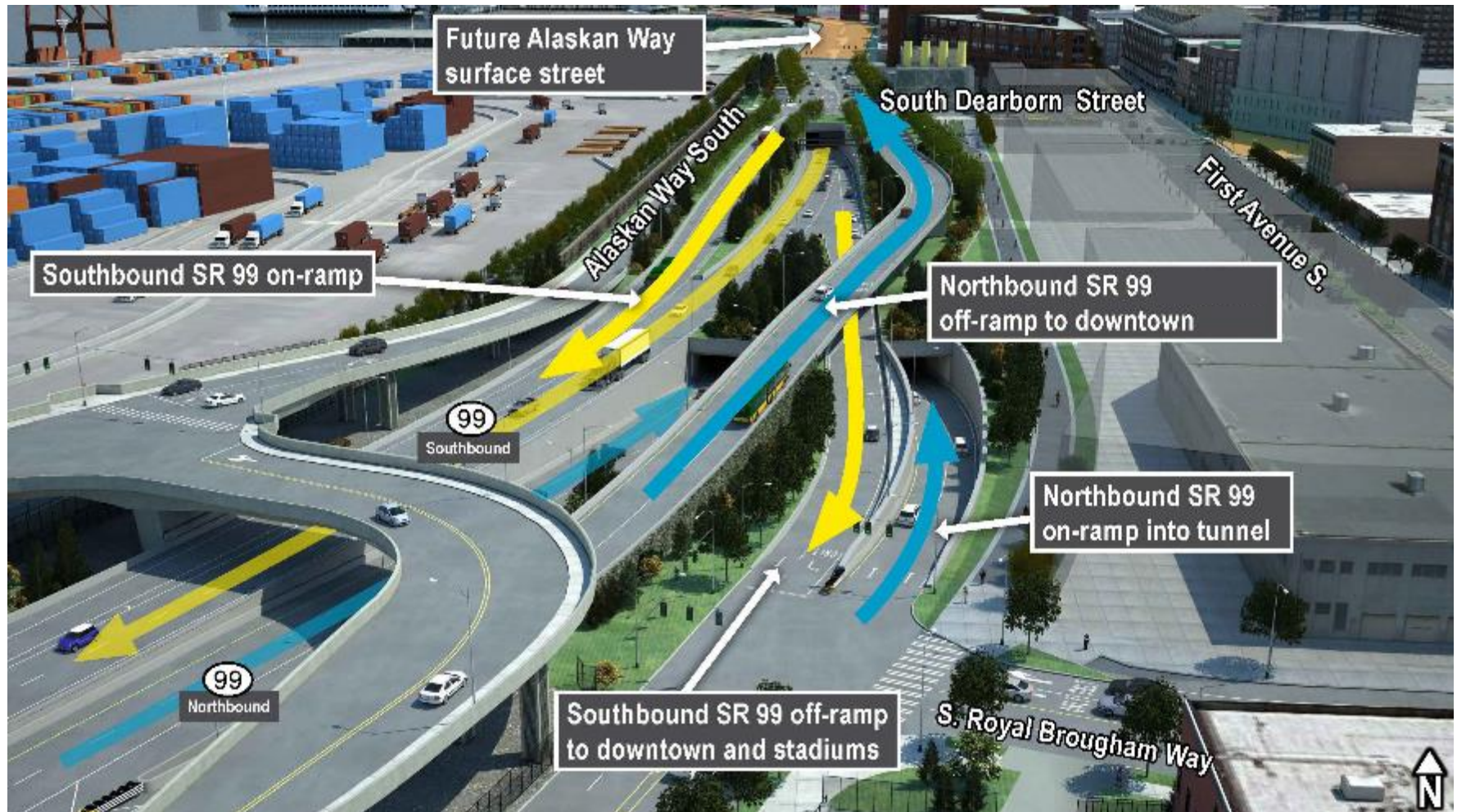

Construction after the SR 99 tunnel opens



Viaduct removal: Approx. 6 months

Filling and sealing the Battery Street Tunnel: Approx. 24 months

North surface street connections: Approx. 15 months





King County

Southend transit pathways sequence

During AWW full Closure – Before tunnel opens

- **Duration:** 4 - 5 weeks
- **Affected routes:** 21x, 37, 55, 56, 57, 113, 120, 121, 122, 123, 125, C Line

Interim pathway via 1st Ave S

- **Duration:** 9 months – 1 year
- **Affected routes:** 21x, 37, 55, 56, 57, 113, 120, 121, 122, 123, 125, C Line

Permanent southend pathway

- **Duration:** Permanent
- **Affect:** When the Viaduct Demolition, Waterfront, and Columbia St 2-Way Configuration projects are complete, this pathway will use transit lanes on SR 99, Alaskan Way Surface St, and Columbia St for both ingress and egress of the Seattle CBD.



The information included here has been compiled by King County Metro staff from a variety of sources and is subject to change without notice.



King County

SR 99 closure North end transit pathways

- Aurora buses will be impacted by North Portal area work
- Routes includes E, 5, 5X, 26, 28







The information included here has been compiled by King County Metro staff from a variety of sources and **is subject to change without notice.**

Water Taxi



- 10 minute ride from Seacrest Park in West Seattle
- 22 minute ride from Vashon Island to downtown
- Second vessel for West Seattle routes
- Additional 250 parking spots at Pier 2 with shuttle to Seacrest Park
- Additional parking at Harbor Ave SW and SW Bronson Way
- Dedicated Vanshare parking at Don Armeni Park
- Added shuttle service (Route 773 and 775) from the Junction and Alki Beach

Responding to the SR 99 closure

-  Actively monitor and adjust traffic system; staff operations centers 24/7; deploy police at key transit intersections
-  Extend transit priority hours on 3rd Avenue to 6AM to 7PM; add bus trips on key Metro routes and standby coaches to maintain schedules; and provide additional Water Taxi service
-  Modify and schedule permitted construction work for maximum travel capacity; temporarily restrict parking
-  Work cooperatively with downtown Seattle employers to reduce drive alone trips; provide SR 99 consultations and support through Commute Seattle
-  Collaborate on a regional communications and outreach effort, including more than 100 meetings with community groups, stakeholders, and businesses

SR 99 closure and tunnel opening: plan and prepare

We need the public's help: make a plan for #Realign99

- Stay informed and sign up for alerts
 - www.seattle.gov/traffic
 - www.kingcounty.gov/getready
 - www.99tunnel.com
- Shift your travel time
- Bike or walk
- Carpool or vanpool
- Use transit, particularly light rail and King County Water Taxi
- Flex your work schedule to avoid peak travel times, work from home, postpone discretionary trips, take time off
- Be prepared for your new travel route when the tunnel opens



We're entering a new normal



SDOT

Know Before You Go:

www.seattle.gov/traffic

Twitter:

@seattledot

@SDOTtraffic

#seattlesqueeze

Commute Seattle

<https://commuteseattle.com/sr99/>

Port of Seattle

<https://www.portseattle.org/projects/alaskan-way-viaduct-replacement-program>

King County Metro

Metro Trip Planning Resources for buses, light rail, ride share and water taxi:

<https://kingcounty.gov/getready>

Sound Transit

<https://www.soundtransit.org/>

WSDOT

Twitter:

@WSDOT_traffic

@BerthaDigsSR99

#Realign99

Email:

viaduct@wsdot.wa.gov

BACK POCKET



King County

SR 99 closure transit pathways

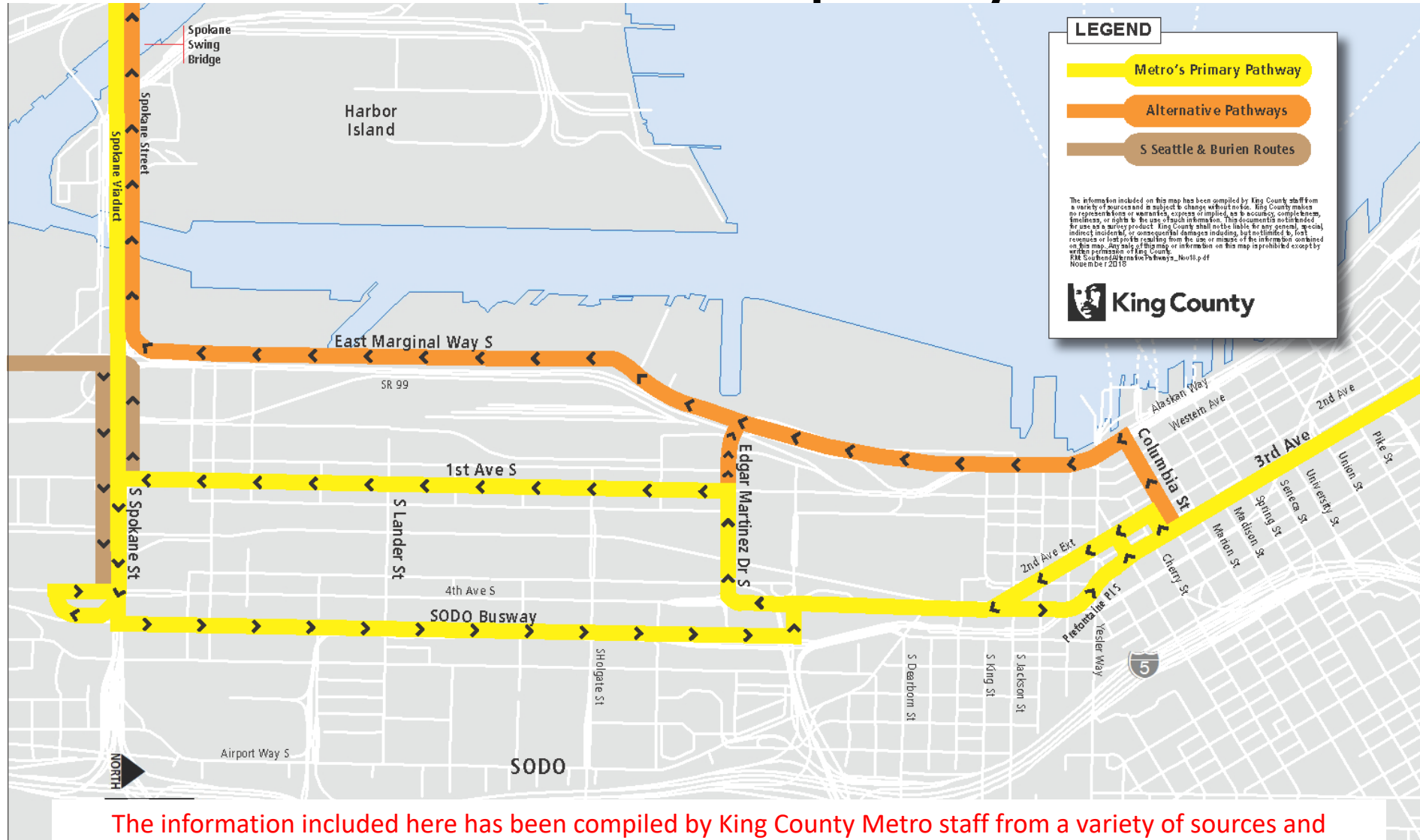

The information included here has been compiled by King County Metro staff from a variety of sources and is subject to change without notice.

2016 SR 99 closure

Travel time: Bellevue to Seattle (I-90 westbound)

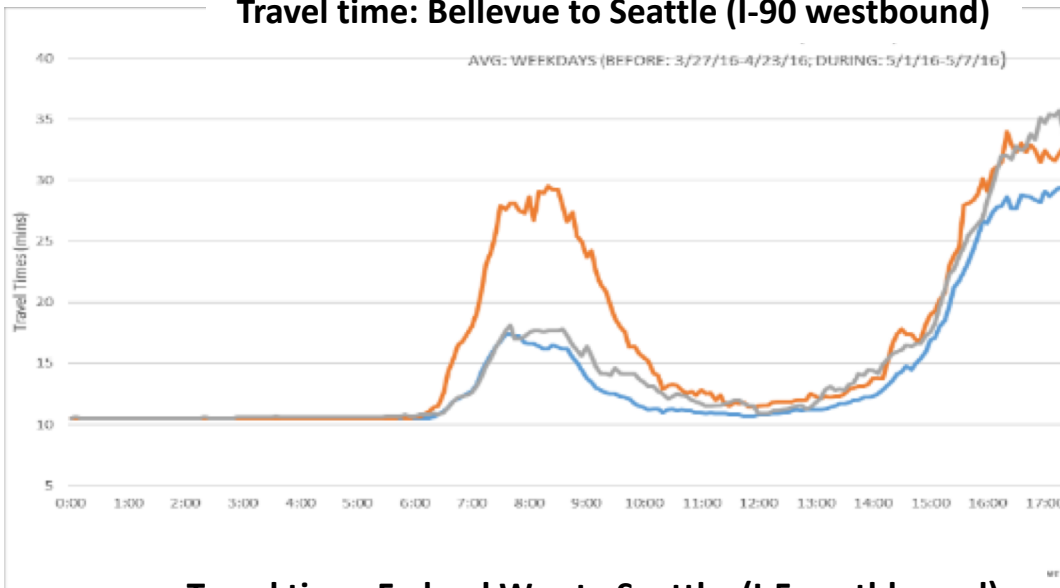

Travel time: Federal Way to Seattle (I-5 northbound)

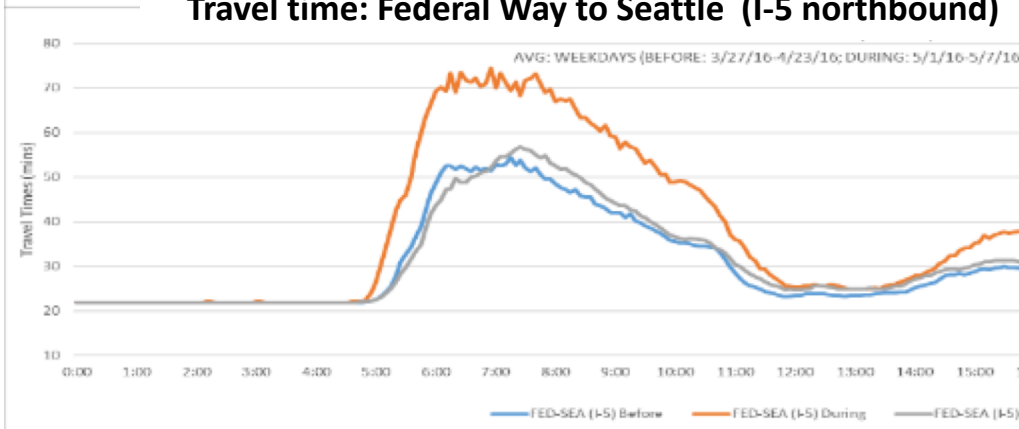

What we experienced during nine-day SR 99 closure in 2016

- Region-wide impacts: higher travel times on I-5, SR 520, I-90
- Peak commutes started earlier and lasted longer
- More vehicles on downtown streets
- Sound Transit commuter rail ridership increased by 5 to 10%
- West Seattle water taxi ridership increased 135%, Vashon passenger ferry service increased by 27%
- Longer travel times for King County Metro buses rerouted off SR 99
- More cyclists on the road to avoid congestion

Using the new SR 99 tunnel



North portal freight routes during #Realign99 closure

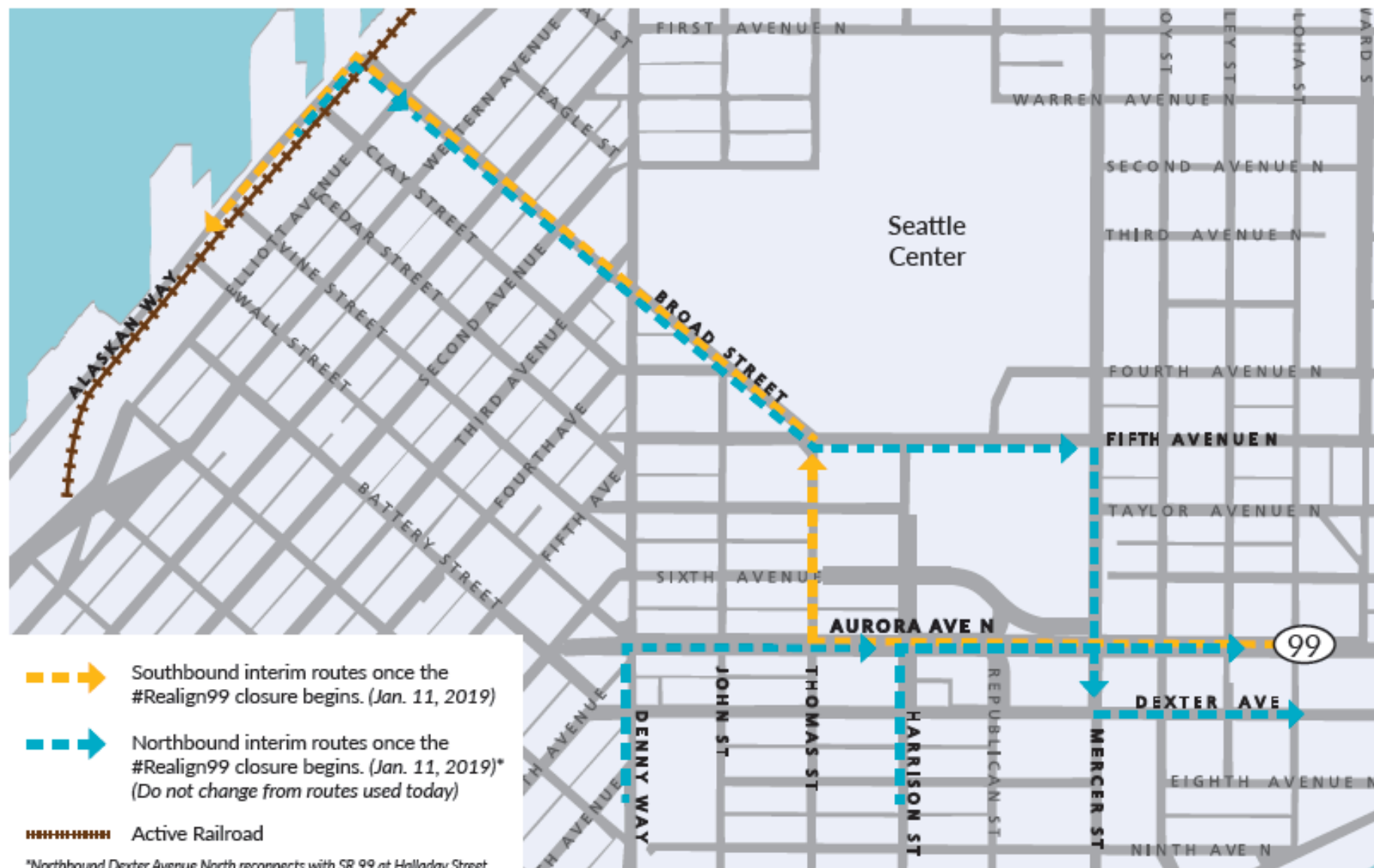

North portal freight routes after the SR 99 tunnel opens



minutes during #Realign99 closure

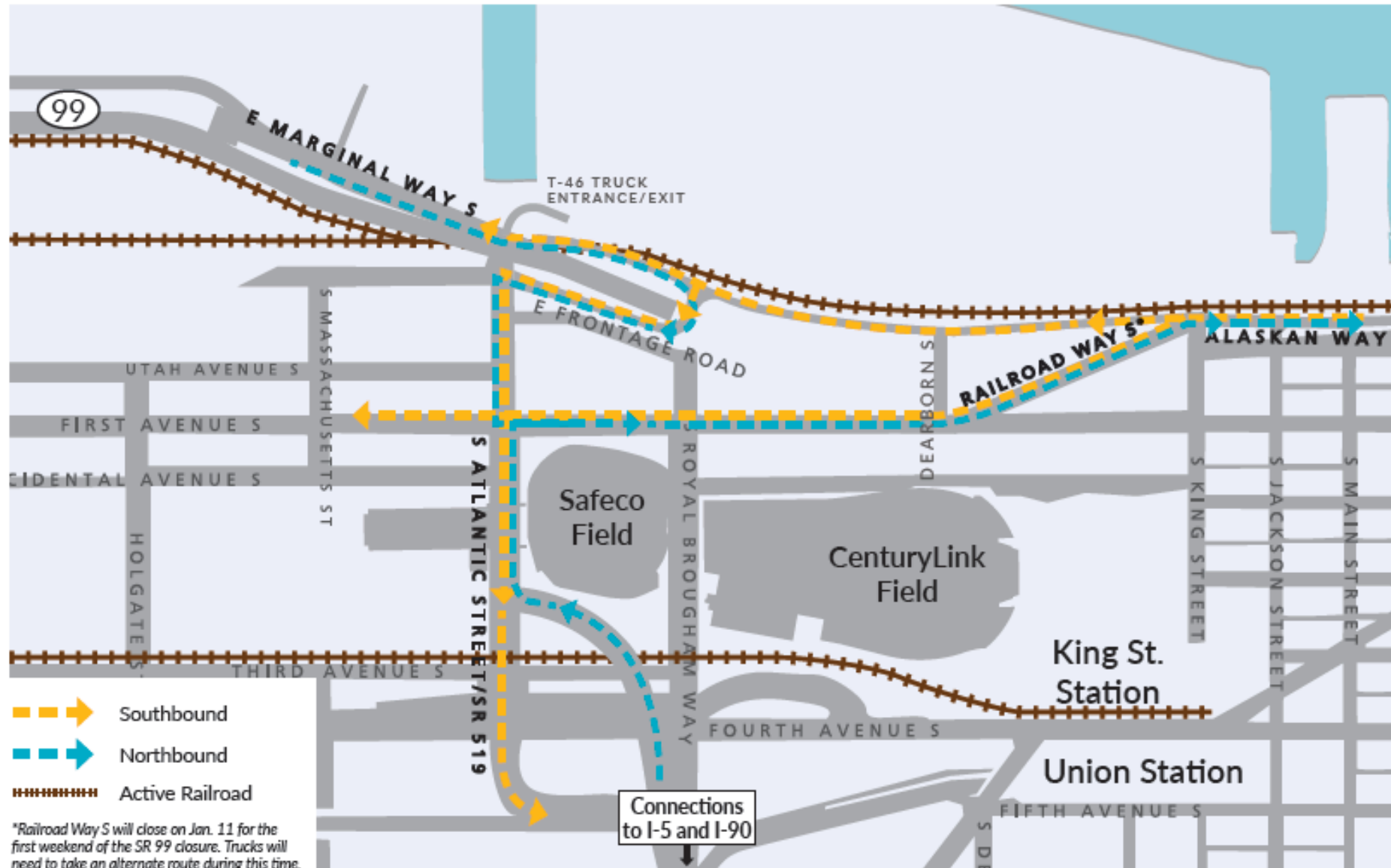

South portal freight routes after the SR 99 tunnel opens

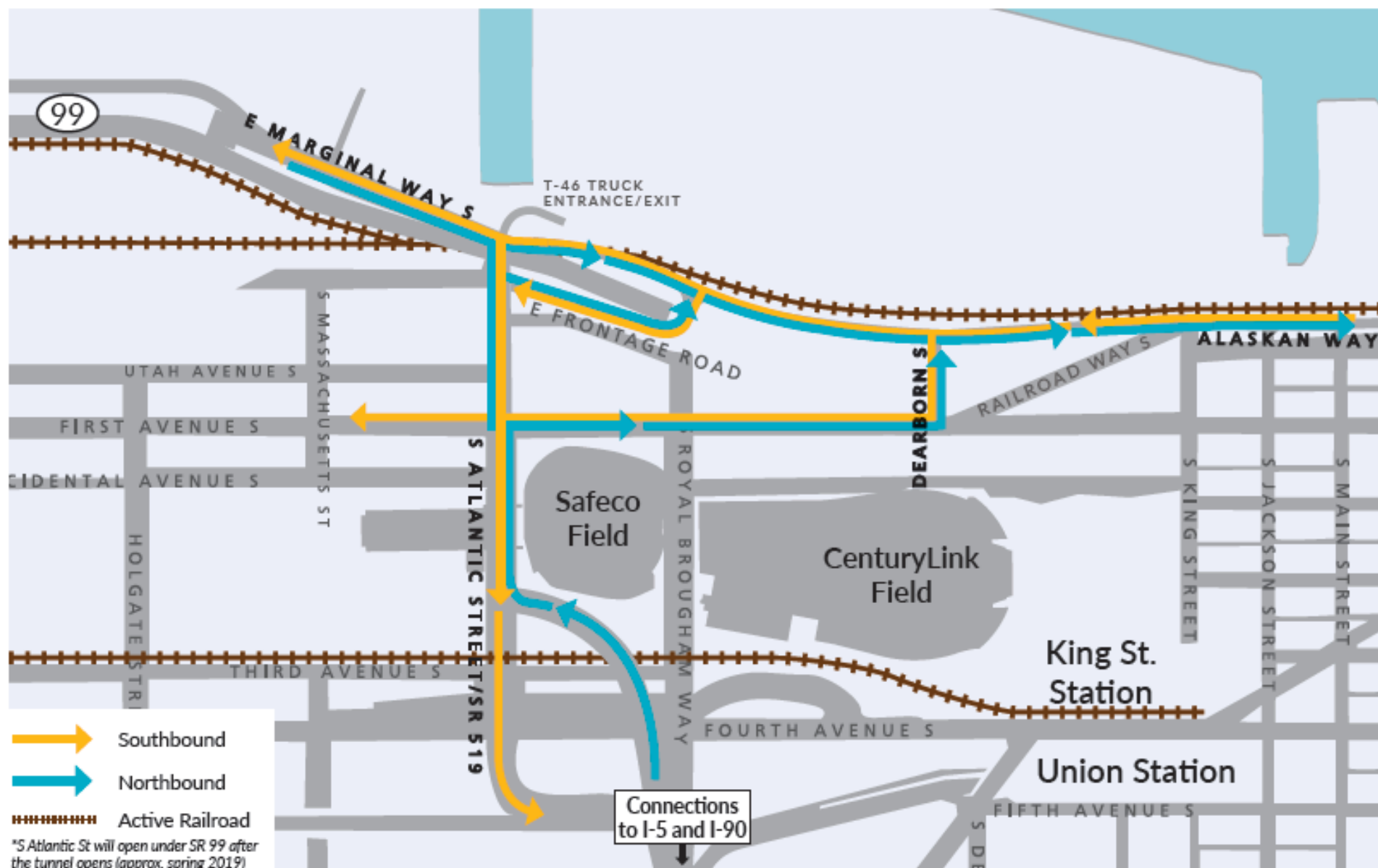

SR 99 closure / tunnel opening multi-agency planning effort

