

Seattle Public Utilities

45th Ave SW Culvert Replacement Project

Seattle City Council

Parks, Public Utilities & Technology Committee

September 10, 2025

Purpose of Legislation

To authorize Seattle Public Utilities to acquire, by negotiation or eminent domain, 10 permanent easements and 18 temporary easements along Fauntleroy Creek, required to construct the 45th Ave SW Culvert Replacement Project.

Projects Overview

- Two projects to replace failing culverts that are fish blockages
- Will replace with **fish passable culverts**

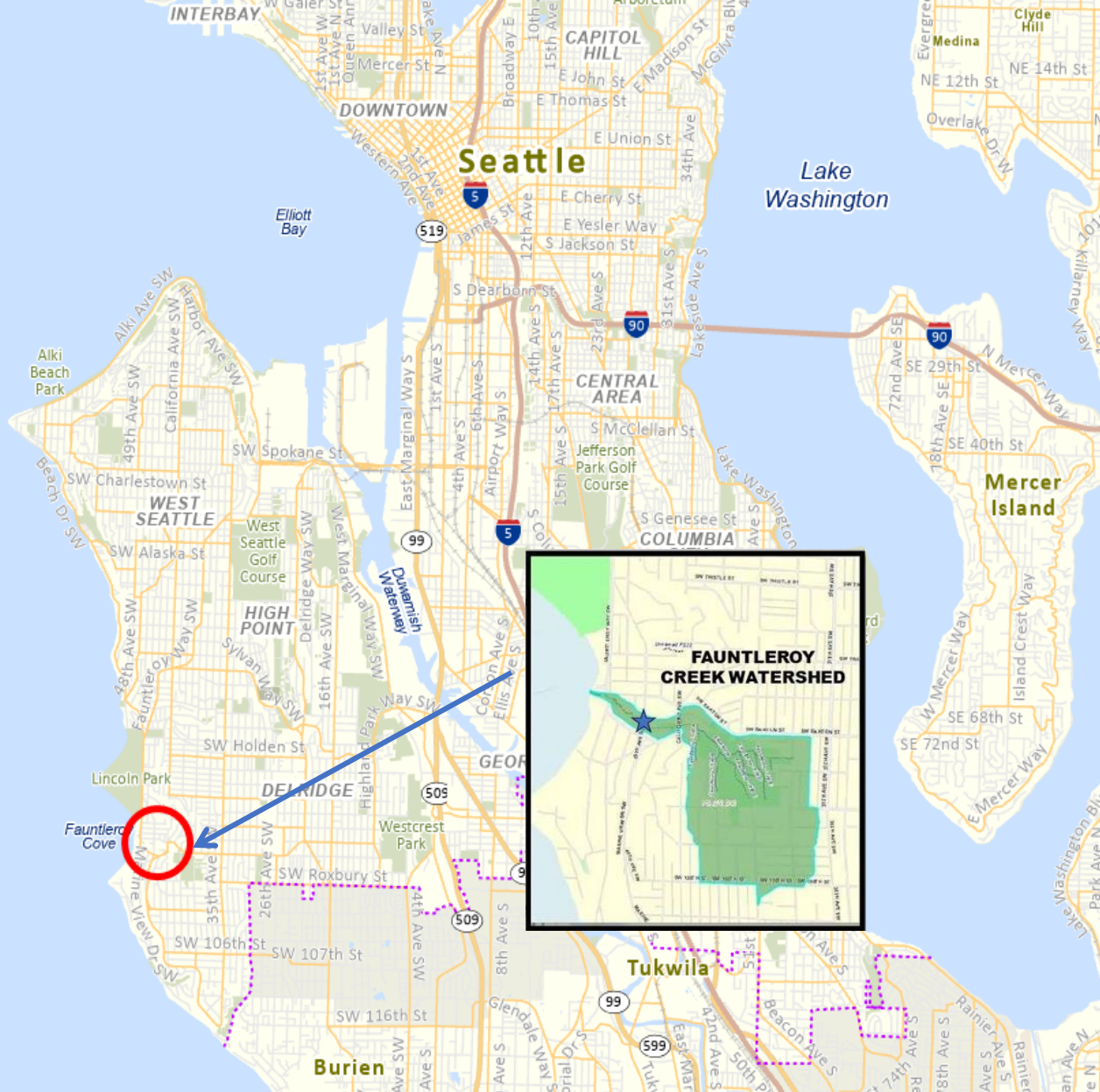

*Spawning salmon in Fauntleroy Creek
(photo courtesy of Whitney F.)*

Fauntleroy Creek Context

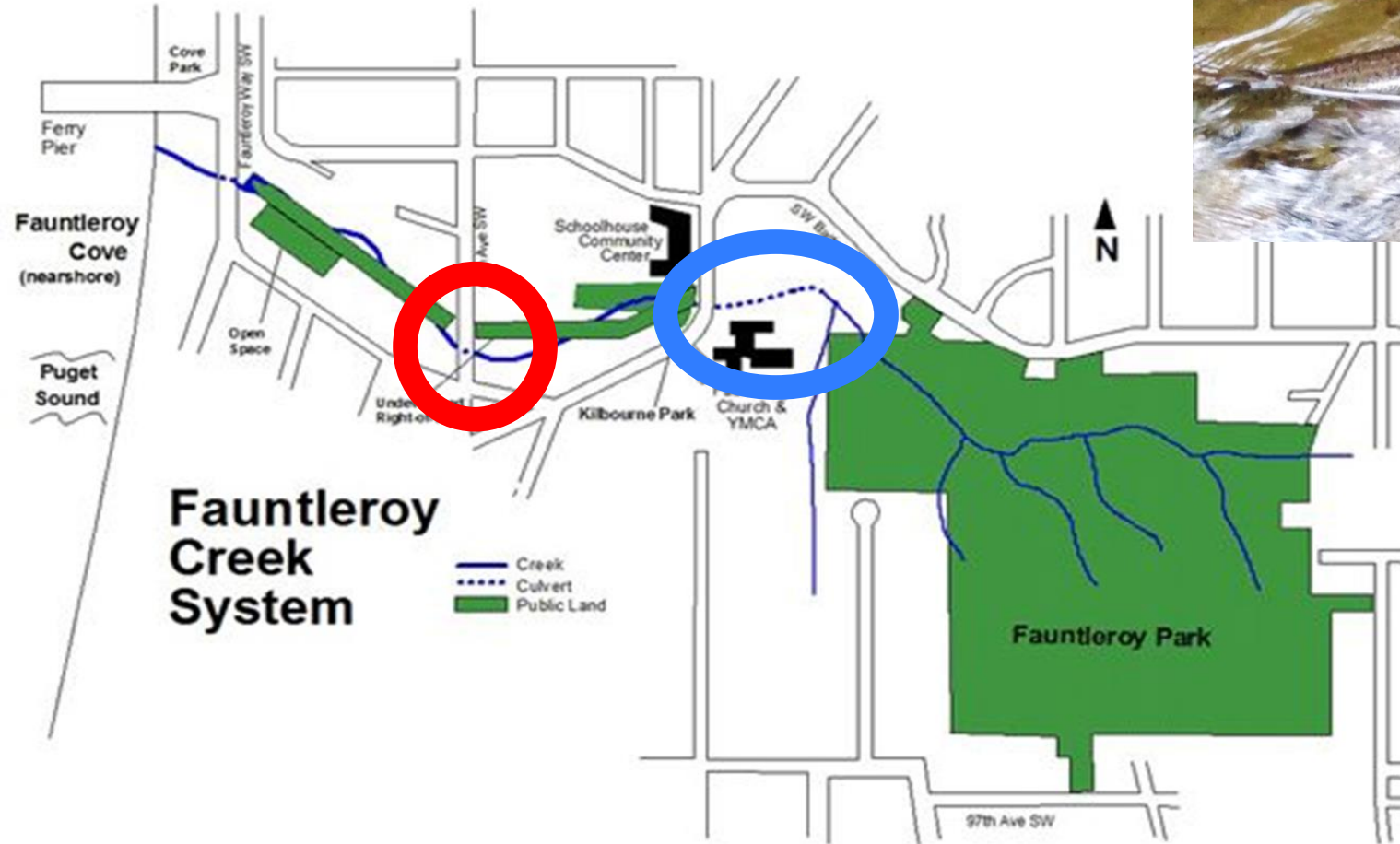

*Spawning salmon in Fauntleroy Creek
(photo courtesy of Whitney F.)*

California Culvert Emergency Project Schedule + Risks

- Implementing Emergency Project to line the pipe September 2025
- Permanent solution planned for construction initiation in 2028

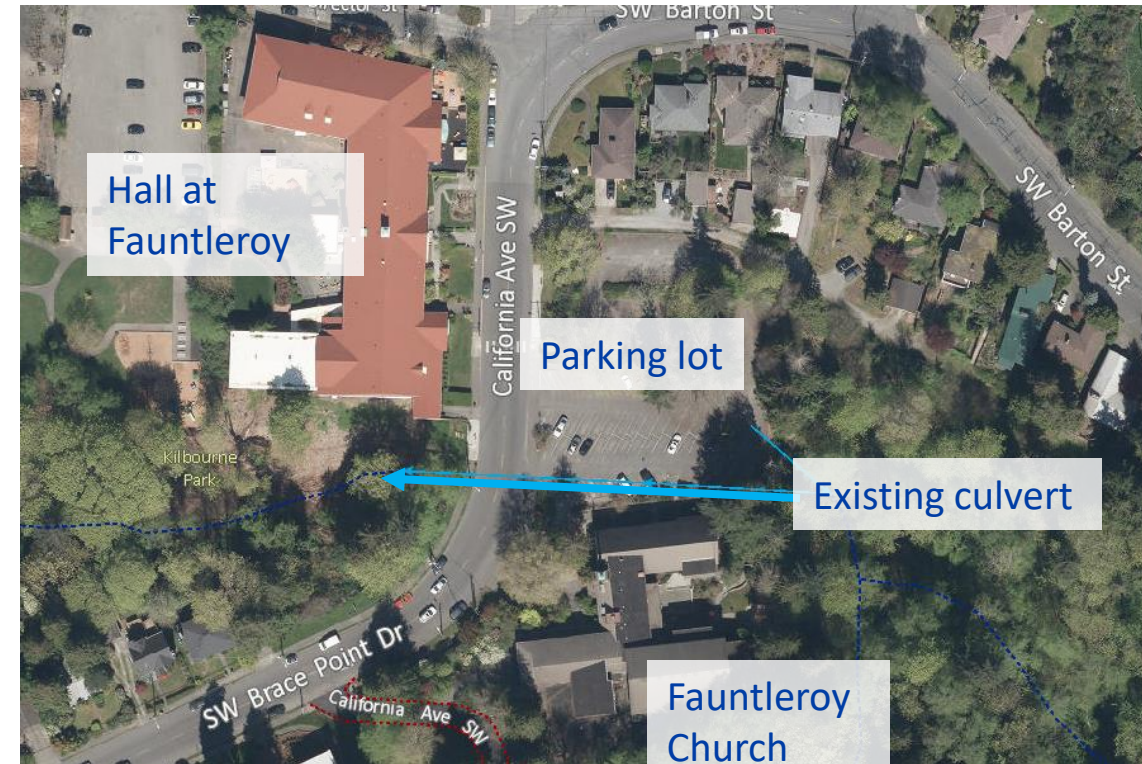

45th Ave SW Culvert Project Purpose



45th Ave SW Culvert Project Schedule

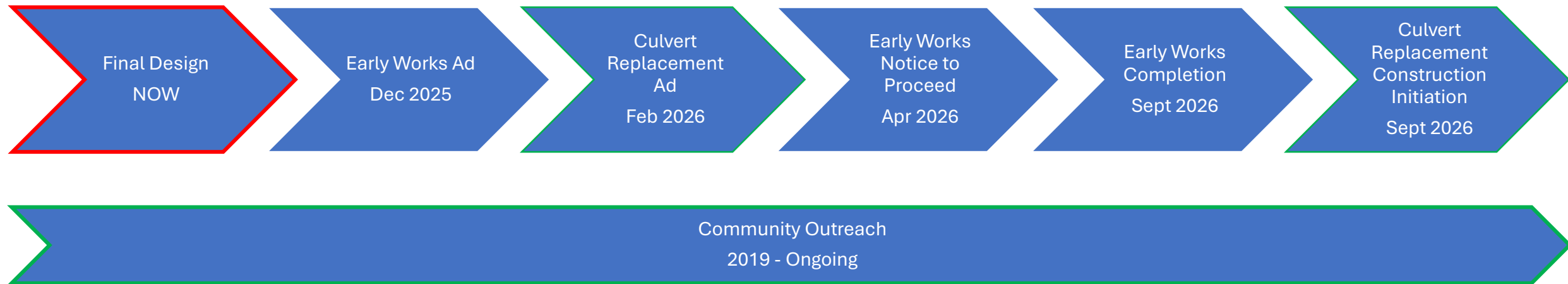

45th Ave SW Culvert Replacement Benefits

- Restore fish passage & improve habitat
- Supports Tribal Treaty rights and SPU's commitment to racial and social justice
- Enhance Community connection with Fauntleroy Creek Watershed
- Provide safer working conditions for SPU's maintenance crews



45th Ave SW Culvert Replacement Project



2-foot pipe
replaced with
14-foot wide
culvert

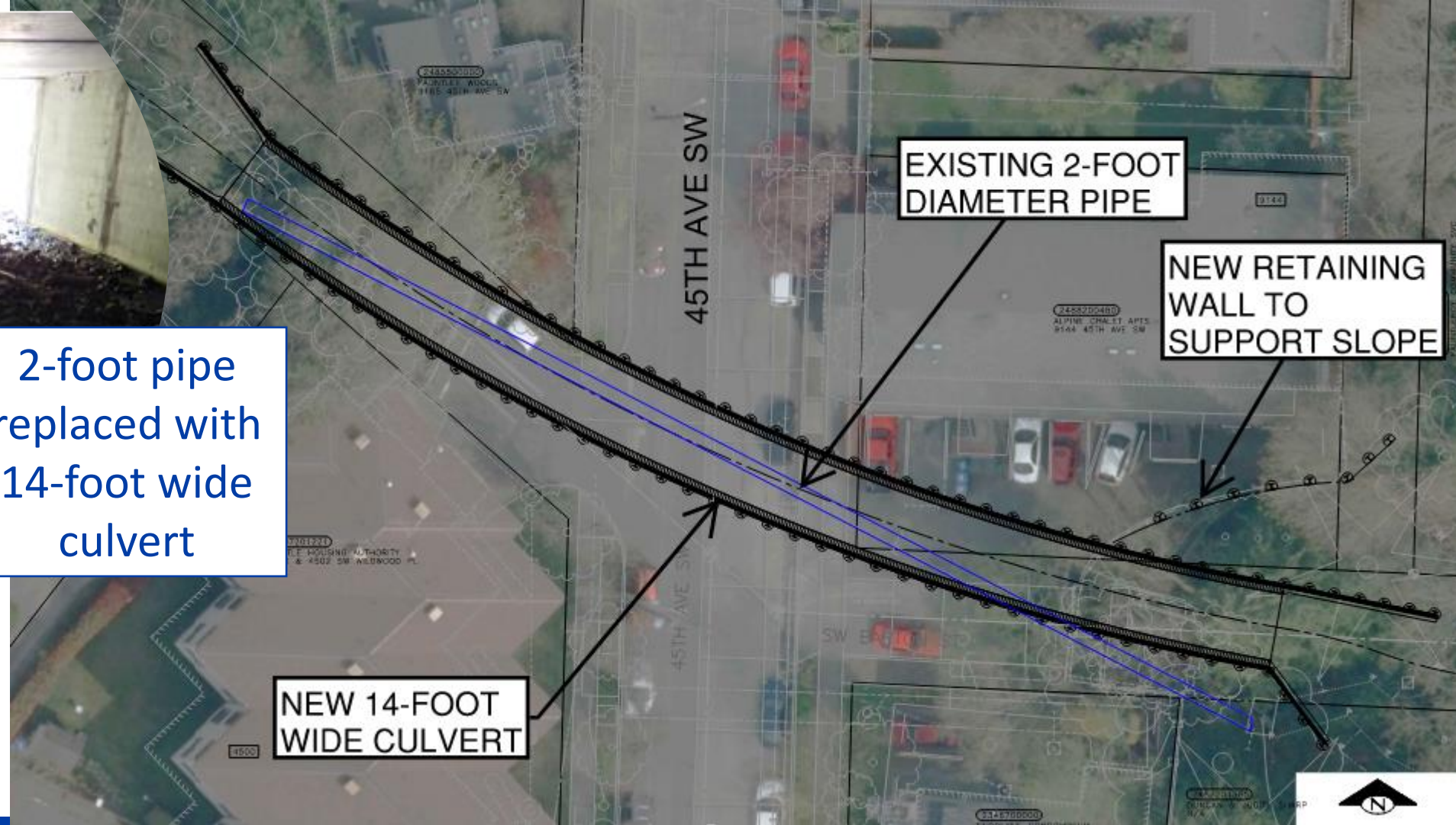

Parcels & Project Site

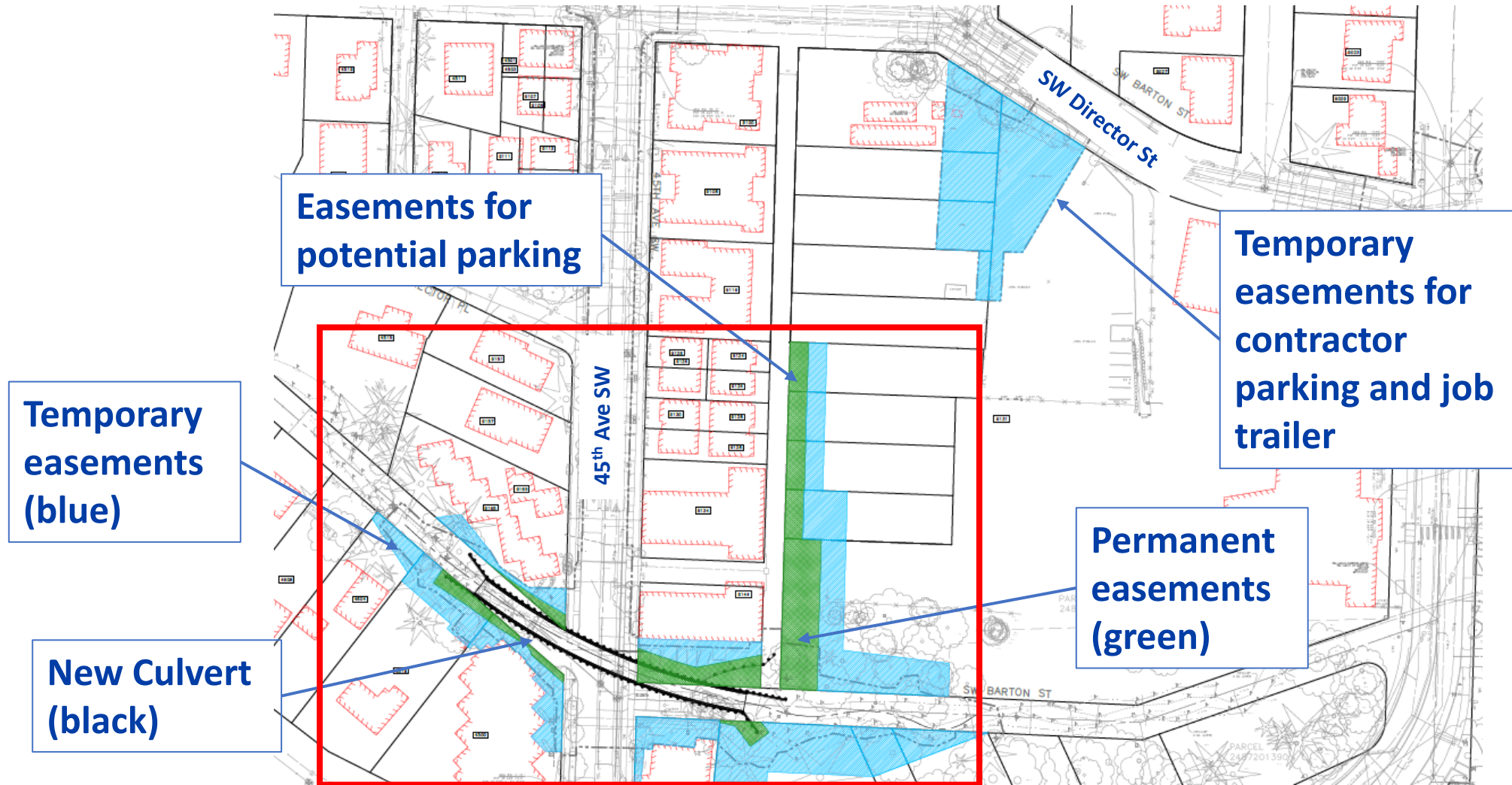

Parcels & Project Site

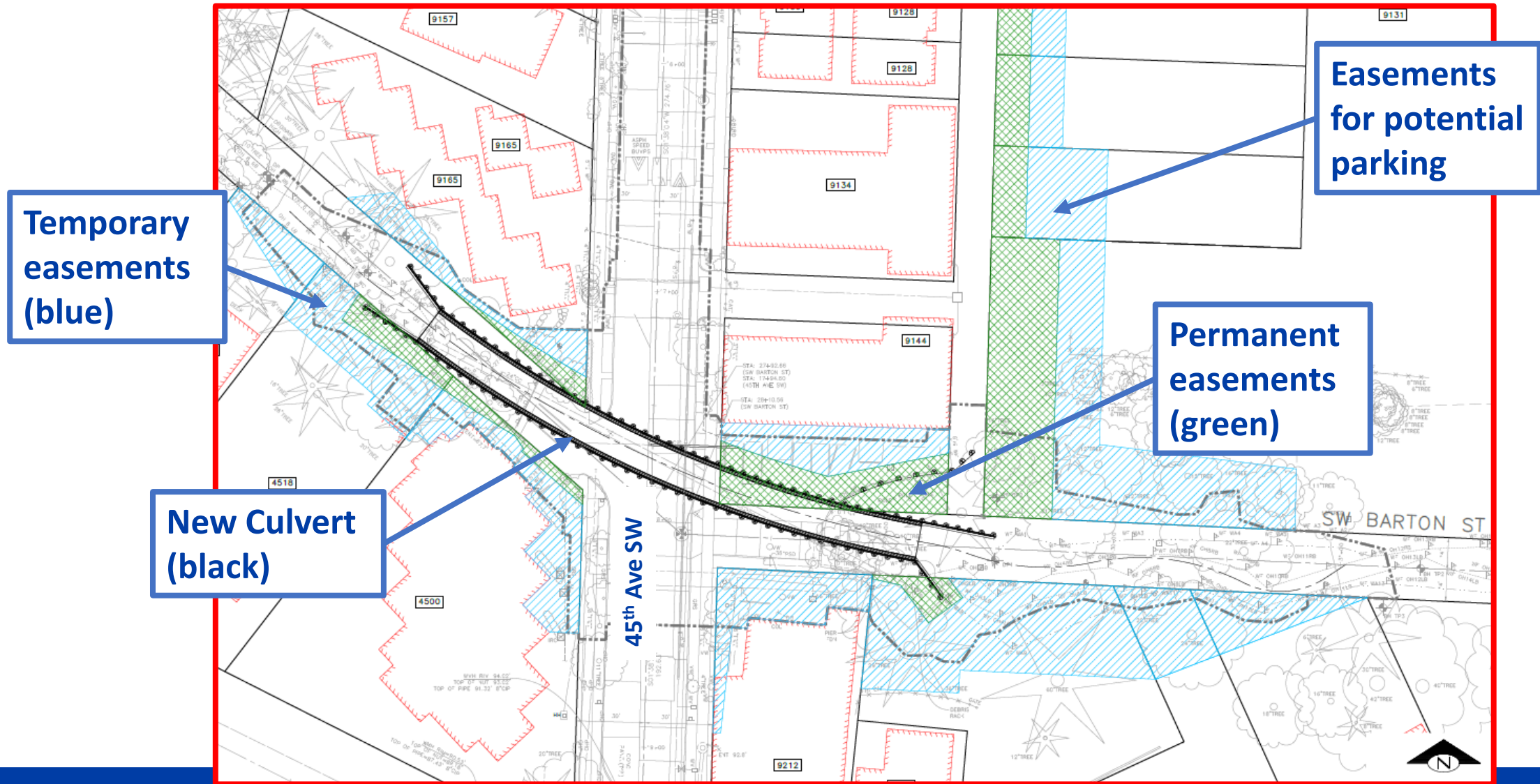

Property Acquisition Timeline

- Project plan includes acquiring 10 permanent and 18 temporary easements through negotiations.
- If negotiations fail, SPU will acquire the rights through eminent domain by filing a condemnation petition, authorized by City Council.
- Preparing for Condemnation & Appeal, which would delay start of construction for the full culvert.



Questions?



Benefits & Impacts of Legislation



45th Ave SW Landing Area

Maps & Photos of Parcels and Project Site



Maps & Photos of Parcels and Project Site

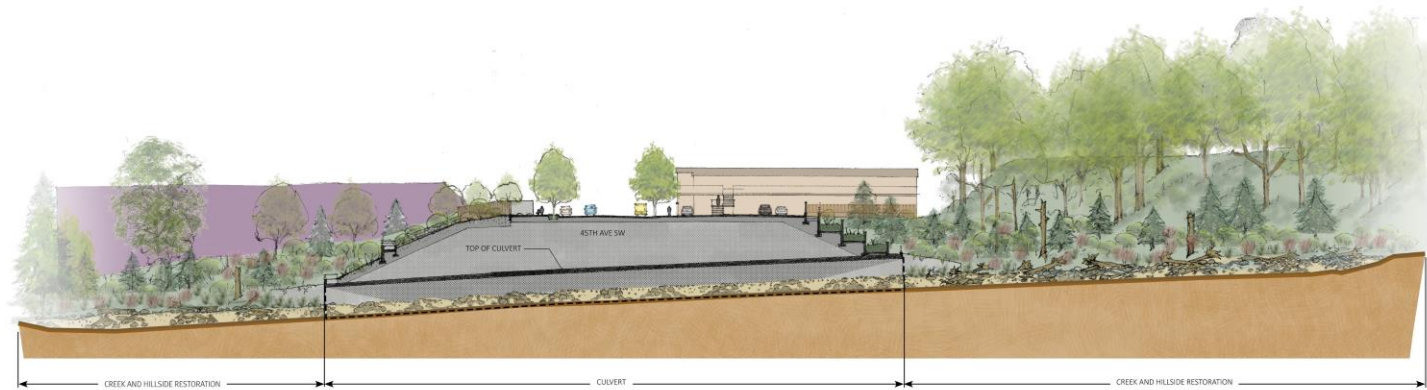

FAUNTLEROY CREEK RESTORATION
SECTION VIEW THROUGH CULVERT LOOKING NORTH

DRAFT
2025-05-15



Maps & Photos of Parcels and Project Site



Maps & Photos of Parcels and Project Site



Maps & Photos of Parcels and Project Site



Maps & Photos of Parcels and Project Site



Maps & Photos of Parcels and Project Site



Maps & Photos of Parcels and Project Site



Maps & Photos of Parcels and Project Site



Maps & Photos of Parcels and Project Site



Maps & Photos of Parcels and Project Site



45th Ave SW Culvert Replacement and Fish Passage Restoration Project

SEATTLE PUBLIC UTILITIES / SEATTLE, WA

Notes:

1. Vehicular access to 45th Ave SW will be provided for local traffic only for the duration of construction.
2. Pedestrian access through this portion of 45th Ave SW may not be available during times of heavy construction. Non-vehicular access alternatives will be developed as design progresses.

LEGEND

- Fauntleroy Creek
- Primary Work Area (No Street Parking) ⁽¹⁾
- Potential Area of Additional Impacted Street Parking ⁽¹⁾
- Road Closed - Contractor Access Only
- Bus Stop



Maps & Photos of Parcels and Project Site



Outreach during Design Phase

