

LANDMARK LEGAL DESCRIPTION
 THAT PORTION OF LOT 43, PLAT OF SOMERVILLE FILED ON JANUARY 24TH, 1887 IN VOLUME 2, PAGE 63 OF PLATS, RECORDS OF KING COUNTY, WASHINGTON, MORE PARTICULARLY DESCRIBED AS FOLLOWS: BEGINNING AT THE INTERSECTION OF THE SOUTHEAST MARGIN OF BEACON AVENUE, SAID MARGIN BEING 63' SOUTHWEST AND PARALLEL WITH IT'S CENTERLINE ACCORDING TO THE CITY OF SEATTLE ORDINANCE NUMBER 30071, AND THE CENTERLINE OF VACATED SHAFFER AVENUE SOUTH ACCORDING TO SURVEY FILED UNDER RECORDER'S NUMBER 20030814900008, RECORDS OF KING COUNTY, WASHINGTON. THENCE SOUTH 0°33'57" WEST ALONG SAID CENTERLINE, A DISTANCE OF 196.70 FEET TO THE NORTH LINE OF THE PLAT OF DUWAMISH HEIGHTS AS RECORDED IN VOLUME 15 OF PLATS, PAGE 96, RECORDS OF KING COUNTY, WASHINGTON. THENCE NORTH 87°30'12" WEST ALONG SAID NORTH LINE, A DISTANCE 530.53 FEET TO A POINT ON EAST MARGIN OF VACATED PERKINS AVENUE. THENCE NORTH 0°39'12" EAST ALONG SAID EAST MARGIN, 289.63 FEET TO IT'S INTERSECTION WITH THE SOUTH MARGIN OF VACATED SOUTH ORCHARD STREET; THENCE SOUTH 87°24'16" EAST ALONG SAID SOUTH MARGIN, 419.37 FEET TO SAID SOUTHEAST MARGIN OF BEACON AVENUE. THENCE SOUTH 44°30'17" EAST ALONG SAID SOUTHEAST MARGIN, A DISTANCE OF 135.15 FEET TO THE POINT OF BEGINNING. SITUATED IN KING COUNTY, WASHINGTON.

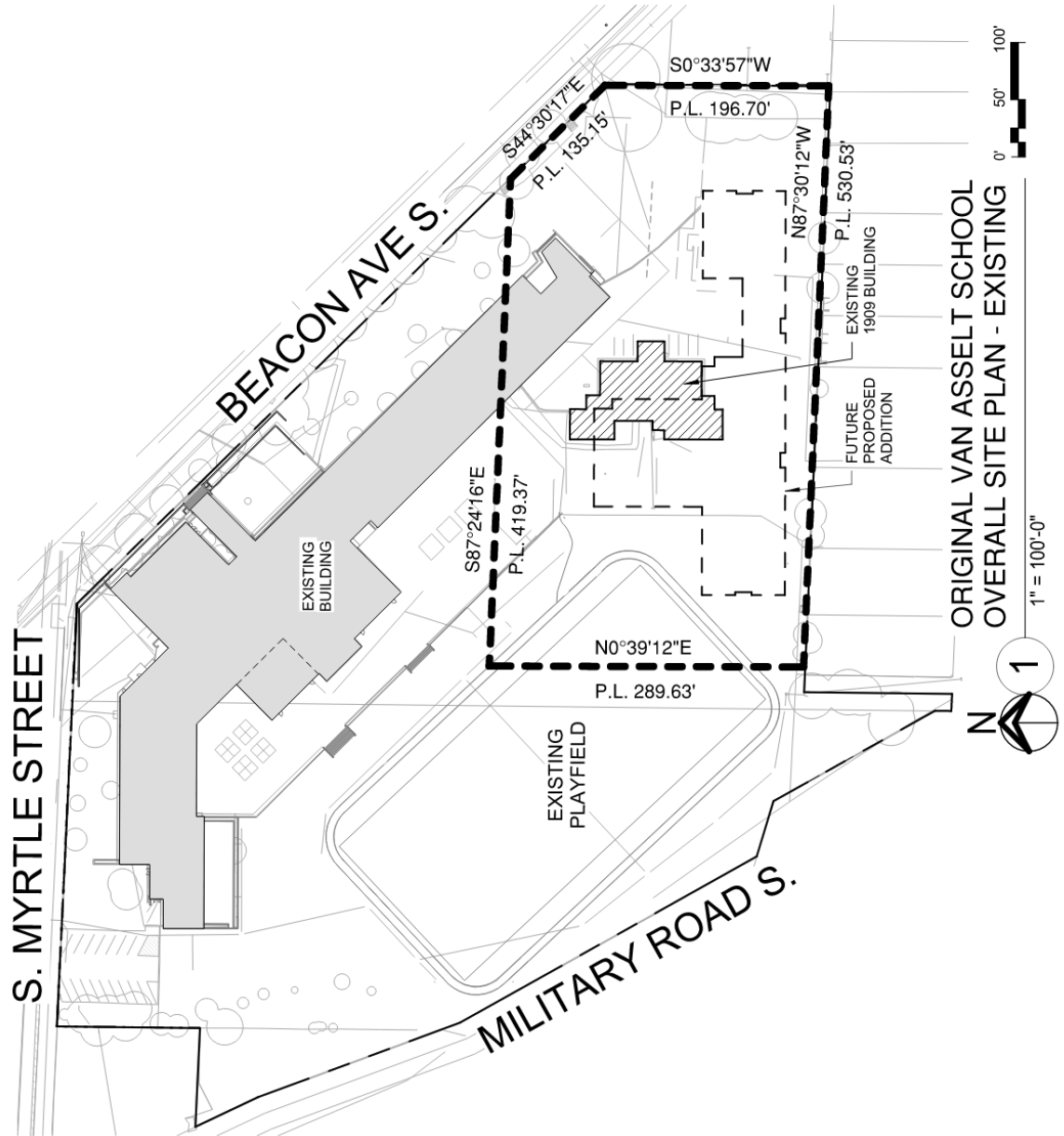

ORIGINAL VAN ASSELT SCHOOL
 OVERALL SITE PLAN - EXISTING

1" = 100'-0"

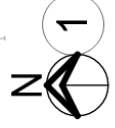

ATTACHMENT A