

Figure 1. Area in Gray Hatch Identified by Seattle Public Utilities as a Flood-prone Area in Addition to FEMA FIRM Panels 0329G and 0330G for King County.

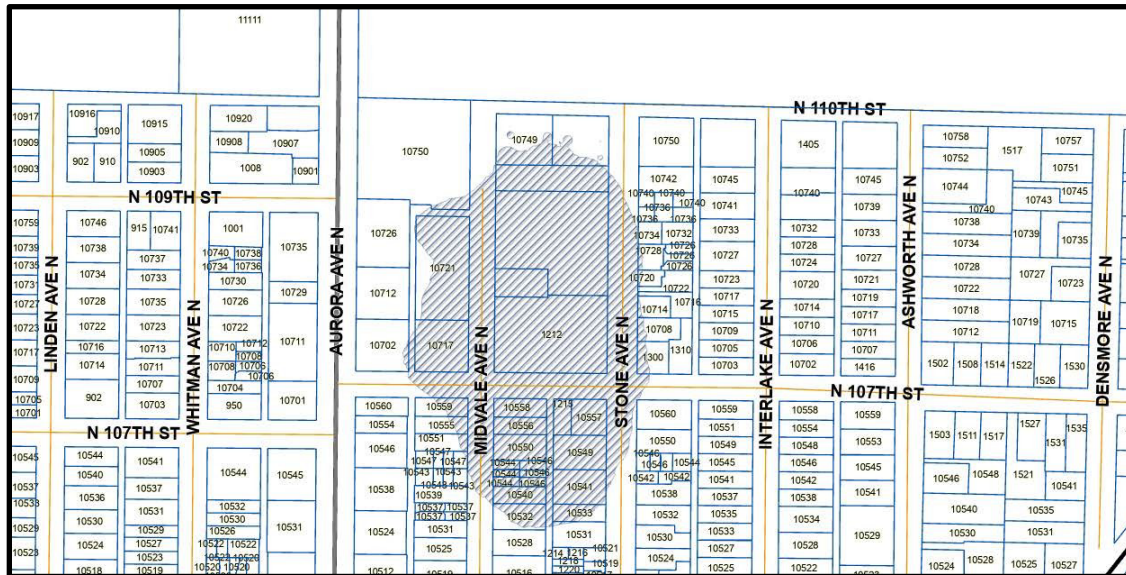

Figure 2. Area in Gray Hatch Identified by Seattle Public Utilities as a Flood-prone Area in Addition to FEMA FIRM Panel 0635G for King County.



Figure 3. Area in Purple Hatch Identified by Seattle Public Utilities as a Flood-prone Area in Addition to FEMA FIRM Panel 0640G for King County.

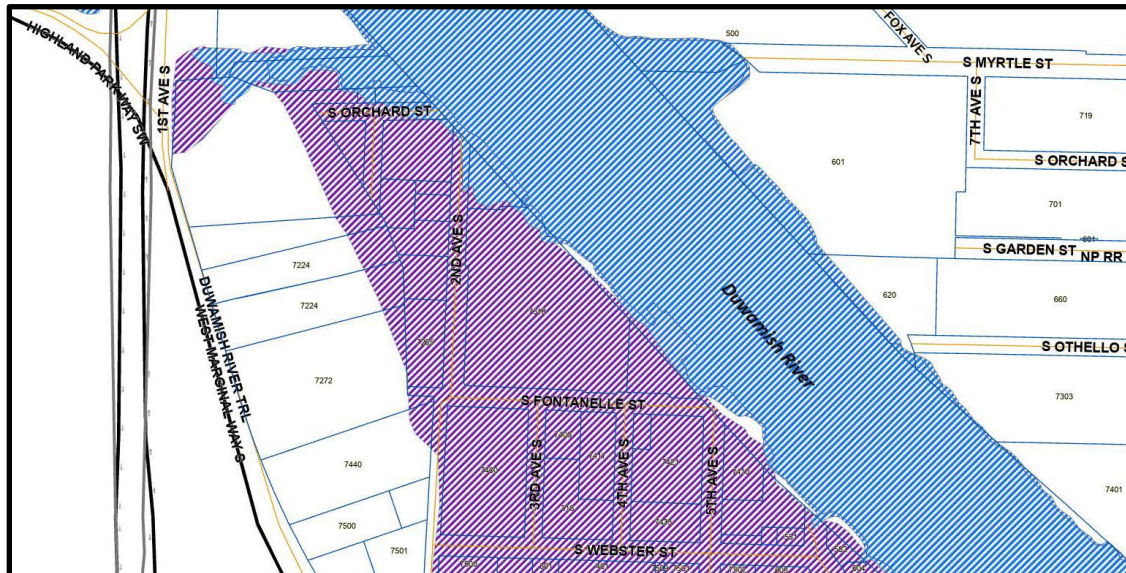

Figure 4. Area in Purple Hatch Identified by Seattle Public Utilities as a Flood-prone Area in Addition to FEMA FIRM Panel 0640G for King County.

